



WORLD'S



STOP FOUNDATION SHOP

**KAMAR**  
INFRASTRUCTURE PVT. LTD.

WE PART OF  
MAKING BEAUTIFUL







*We Part of Making Beautiful World*



**KAMAR**  
**INFRASTRUCTURE PVT. LTD.**

World's One Stop Foundation Shop





KIPL has the manufacturing facility at the Taloja Navi Mumbai. The Plant is spread across 5 acres of prime land developed by different sheds and RCC structures as per the department requirement for the best work to be carried out according to the Departments.

The Departments can be categorized as:

- 1) **OFFICE**
- 2) **FABRICATION SHOP**
- 3) **FORGING DEPARTMENT**  
**HEAT TREATMENT**
- 4) **MACHINE MALL/ CNC ROOM**  
**CONVENTIONAL LATHE SHOP**
- 5) **STORE**
- 6) **KELLY FABRICATION SHOP**  
**WINCH DEPARTMENT**
- 7) **PRESS SHOP / CNC PROFILE**



## ABOUT US

KAMAR a producer of Kelly Bar, Drilling tools for Piling & Foundation equipment's.

The main products of our company include Kelly Bar, Drilling Buckets, Augers, Core Barrels, Casings, Tremmie Pipe Sockets, Drilling Bits and Cutter teeth, etc. from small to big diameters i.e. 400mm to 3000mm, Heavy duty (HD) & Super Heavy Duty (SHD) for application on clay or rock. Taking "Improving the level of foundation construction technology" as our mission and by depending on a group of engineers and skilled workers with years of experience in foundation drilling engineering and construction design, our products have reached the advanced level in INDIA in terms of the technology and quality as well.

With the latest production facilities and factory, we have completed the designs of drilling tools/attachments and construction methods in many large-scale and complicated foundation projects such as Delhi metro, Chennai metro, Mumbai metro and Monorail which has helped us to win a good reputation among our clients with excellent products and services.

Our efforts to bring forth a world class product range have been leveraged by the support from world class infrastructure. Laced with sophisticated machines and all kinds of amenities, we have been able to deliver our range in bulk well within the limitations of time. Our facility is divided into specialized units like production department, warehouse and packaging department, quality testing laboratory and other units to see through the smooth functioning of our business. Our Infrastructure provides for customization of our product range to comply with the specifications of our clientele.

**Our aim is client satisfaction for service before & after sales.**



# INTRODUCTION



## KAMAR INFRASTRUCTURE

A professional manufacturer of Kelly bar, possesses a leading position of Kelly bar manufacturer in INDIA.

We manufacture Kelly bars of

**BAUER, SOILMEC, MAIT, CASAGRANDE, IMT & OTHER PILING RIGS**

**KAMAR** A Producer Of Drilling Tools For Piling & Foundation Equipments.

**KAMAR** Designs, Manufactures & Markets Augers, Buckets, Core Barrels & Casing

From Small To Big Diameters i.e. 400mm To 3000mm Heavy Duty (HD) & Super Heavy Duty (SHD)  
For Application On Clay Or Rock. Experience Quality With Understanding Of Our Clients' Needs Without  
Forgetting To Be Competitive Has Determined Our Success.

**KAMAR** Specializes In Manufacture Of Desander, Pumps, Piling Winches, Dwall Grabs, Rebar Couplers  
& Drilling Rig Parts And Components.



**KELLY**



**KELLY SPARES**

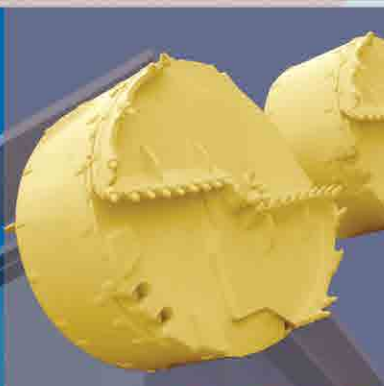

**DRILLING TOOLS**



**WEAR PARTS**

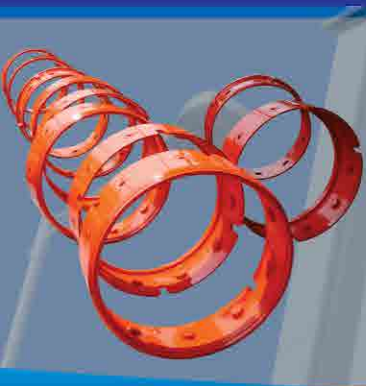

**CASING**



**DESANDER**



**PUMPS**



**PILING WINCHES**



**DWALL GRABS**



**REBAR COUPLERS**



**ANCHORS**



**VIBRO SPARES**





## COMPANY PROFILE

Established in 2005, as a sole proprietorship firm in Taloja, Mumbai, Kamar Infrastructure Pvt. Ltd. has created a niche of its own in the market. Owing to the vast industrial expertise, we have become highly proficient in our domain. We have come up as the most trusted manufacturer, exporter and supplier of dimensionally precise and functionally efficient range of drilling tools and other accessory equipment. With customization facility available, we have been able to satisfy our clients. Complying with international quality standards, we make use of high quality raw material and advanced technology in fabrication of our range.

KAMAR highly focuses on international co-operation and communication. Till present, our products have been exported to many different countries and regions such as Dubai, Singapore, Malaysia, Bangladesh, Iraq, Saudi Arabia, South Africa, Sri Lanka, USA, Australia, etc.

Meanwhile, the brand name recognition is enhancing. In order to offer better local service, KAMAR established a branch in MALAYSIA, Sri Lanka, USA. We have experienced technical team and sales team there. Furthermore, KAMAR founded Dealers in Bangladesh, South Africa, Australia, UAE & Saudi Arabia, Turkey, etc.

With the enlargement of company scale and the increasing of international business, KAMAR pays more and more attention to the international cooperation and communication. Experience quality with understanding of our client's needs without forgetting to be competitive has determined our success.



# KELLY BARS

FOR BAUER - IMT - SOILMEC - CASAGRANDE - MAIT & OTHER PILING RIGS

A Professional manufacturer of **Kelly Bars**, possesses a leading position of **Kelly Bar's** manufacturer in **INDIA**.







## FEATURES OF KELLY BAR

Our Kelly bar tubes imported from Mannesmann, Germany suppliers to OEM's. Special hot-treatment enhances the material's strength more than 800Mpa. All other material are imported from EUROPE. Rib made of alloy hot-treated specially enjoy both high hardness and perfect welding performance, high abrasion-resistance leads to high-reliability. Designed according to advanced Modular-element principle with six ribs laid on tubes.

The advantages of our Kelly bar such as low weight, high strength, high abrasion-resistance, high reliability are safeguarded by technologically superior process, advanced machining equipments and special fixtures.

All Kelly bars are available in interlocking, friction and partially lockable version. Length, Kelly stub and Kelly dimension can be on request. Complete model series and flexible design and manufacture ensure the ability to supply Kelly bar to match with any model of drilling rigs worked in India & Overseas.

Several service engineers and rich experience of repairing Kelly on job site or in workshop benefit customers to enjoy rapid service.

## Computerized Machines For Terminal Joint Fabrication



## Stock of Pipes Imported from Mannesmann, Germany





# FABRICATION SHOP



**Kamar Infrastructure Pvt. Ltd.** is a leader in design, manufacturing and selling of Kelly bar for construction rotary drilling rigs in India & Overseas.

**Kamar Infrastructure Pvt. Ltd.** has been providing quality friction and interlocking Kelly bars for all types of foundation drilling rigs in the market. We can also supply our worldwide customers with Kelly bars that are ideally tailored to your needs with the highest quality and competitive price. We are confident we would be a vital business partner to your construction drilling needs.

## KELLY BAR SERVISING

We provide Repairs and maintenance on customer's working site within the period of the product warranty in India & Overseas. We are specialist in repairs and maintenance various kinds of Kelly bars, including Bauer, Soilmec, Mait, Casagrande, IMT Etc. Our experience will save your money and time and help your drilling rigs work properly.





## STOCK OF KELLY SPARES



**Kamar maintains ample stock of Kelly Spares, Drilling Wear parts Etc. ready in stock so that we can dispatch the materials on the very same day when the orders are received.**





# KELLY PROFILE STRIPS

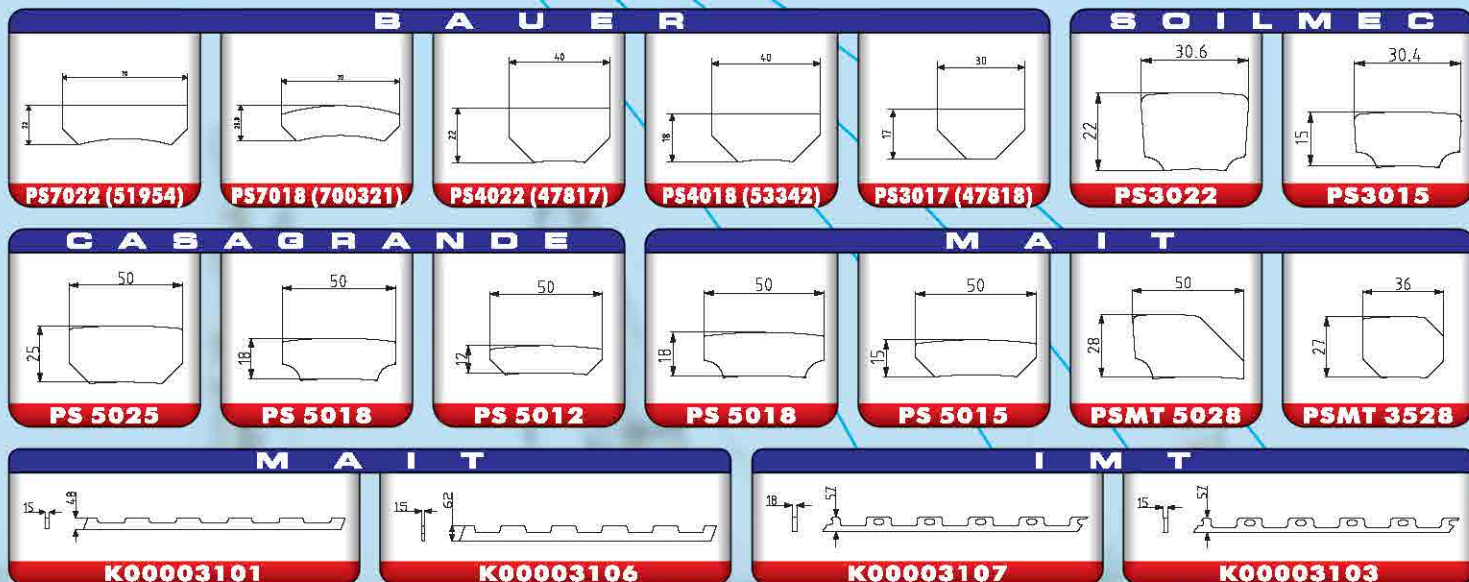

# KELLY BAR SPARES





# WARRANTY CERTIFICATES

**KAMAR INFRASTRUCTURE PVT. LTD.**  
World's One Stop Foundation Shop

**1 Year or 1000 Hrs.** *Certificate OF WARRANTY*

Date :  Certificate No.

To,

KAMAR warrants for one year or 1000 Hrs provided for new Kelly bar.  
Kelly bar type :

KK  S. No.   
Is correctly used by the buyer and his operators.

The warranty period starts with acquisition of the Kelly bar according to agreed delivery basis.  
For the incorrect operation, violence damage and overloading against the operator manuals by the buyer warranty claims will be rejected.

KAMAR / INDIA KELLY BAR	
Type : <input type="text"/>	Year : <input type="text"/> S. No. <input type="text"/>
Transported Dimensions : <input type="text"/>	
Transported Weight : <input type="text"/>	
Kelly Box : <input type="text"/>	
Website : kamartools.com	

The user shall maintain and use the Kelly bar carefully and correctly. Our company will not bear any responsibility for the consequences owing to breach of following provisions :

- Read the specification carefully before using the interlocking Kelly bar and operate the same in terms of the specification.
- Rotary drilling torque and pressure acted on the interlocking Kelly bar by drill rig shall not be greater than the nominal values of the Kelly bar.
- It is not allowed to freely drop down the Kelly bar under any circumstances.
- The Kelly bar can only be used in drilling of vertical pile hole and not be used in other exercises such as soil transfer, hoisting sundries, assemble and disassemble casing and regulate casing or drill tools, etc.
- Never insert the Kelly bar into liquid concrete.
- Electric welding and gas welding shall not be done on the Kelly bar without the direction of our technician or our authority during guarantee period.
- The Kelly bar shall not be rotated clockwise and counter-clockwise during lifting and dropping it.
- Except for allowing unidirectional soil ejecting operation for short helix bits, alternative rotary clockwise and counter-clockwise soil ejecting is not allowed for Kelly bar used in other drill tools.
- The operator must be experienced and trained to work with Kelly bars. During the operation, he has to keep stable emotion, sober mind and swift response.
- It is not allowed to employee non-experienced technician maintaining or disassembling the Kelly Bar.

Additional duties, look as well to the operator-manuals of the Kelly bar.

The warranty time begins with acquisition to the Kelly bar according to agreed delivery basis.

Sales Manager,

**1 Year or 1000 Hrs.** *Warranty*



## FINISH STOCK



For optimal storage stability, the surface on which the bars are stored should be **firm and level** and **uniformly supporting**. A direct contact with the ground must be avoided.

**Risk of damaging components !** Before Putting a kelly into use again after a longer period of storage, the Kelly should be visually inspected for straightness.



# COUNTRIES WE SERVED





[illegible]



# TOOLS MANUFACTURING

## PRESS SHOP



## CNC PROFILE



**CNC Oxy fuel plate cutting machine size for 3 meter x 13 meter**

## PRESS SHOP



**Hydraulic Press 500 Tons 1 Meter Stroke**



**Pipe & Cone Bending Machine 50 MM**



# FABRICATION

## FABRICATION SHED





# LATHE DEPARTMENT

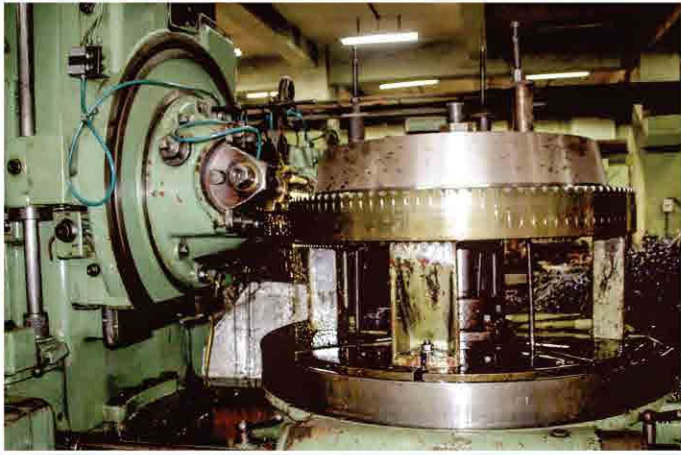



# HEAVY DUTY TOOLS

## SA-HD

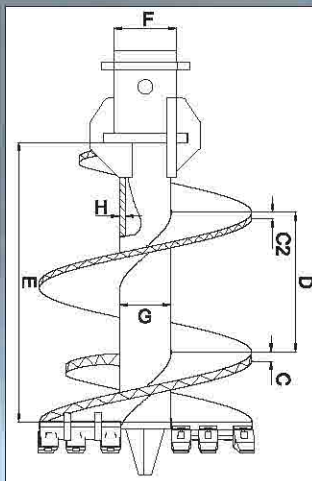
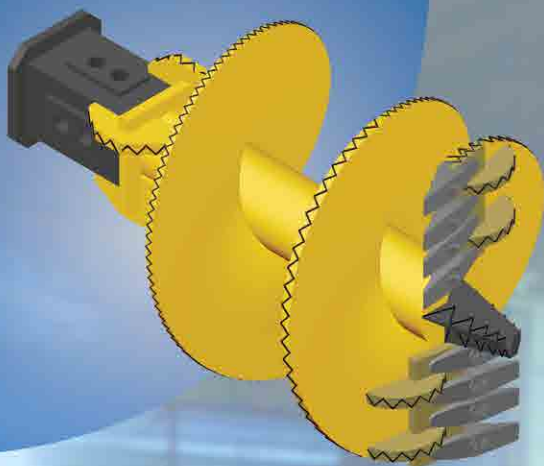

### Features :

- T25 / V19 Soil Teeth
- Double Cutting Edge
- Hard Faced with 650BHN Electrode

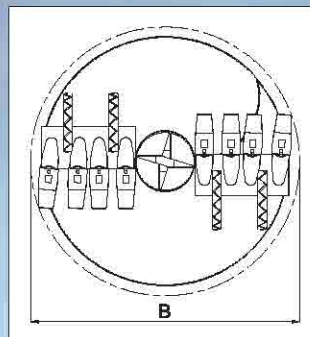

## RA-HD

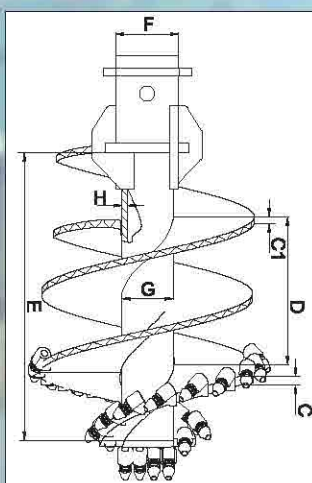
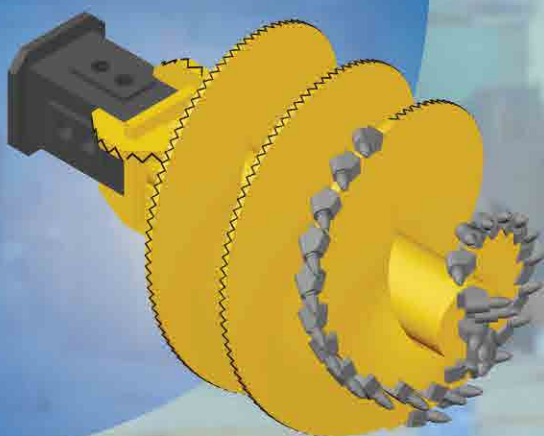

### Features :

- Progressive Shape
- KM-31 / KM-47 Bullet Teeth
- Double Cutting Edge
- Hard Faced with 650BHN Electrode

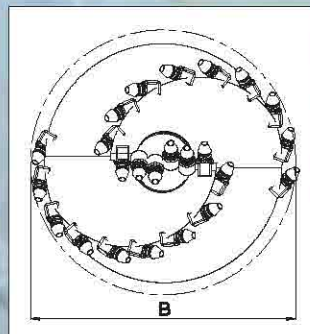

Table for **SA-HD, RA-HD**

A	B	C / C2	D	E	F
PILE DIA (MM)	CUTTING DIA (MM)	FLIGHT THICKNESS (MM)	PITCH (MM)	SHELL LENGTH (MM)	KELLY SIZE (MM)
500	470	40 / 28	500	1000	AS REQD
600	570	40 / 28	500	1000	AS REQD
700	670	40 / 28	500	1000	AS REQD
750	720	40 / 28	500	1000	AS REQD
800	770	40 / 28	500	1000	AS REQD
900	870	40 / 28	500	1000	AS REQD
1000	970	40 / 28	600	1200	AS REQD
1100	1070	40 / 28	600	1200	AS REQD
1200	1170	40 / 28	600	1200	AS REQD
1300	1270	40 / 28	600	1200	AS REQD
1400	1370	40 / 28	600	1200	AS REQD
1500	1470	40 / 28	800	1200	AS REQD

**DIAMETER :**  
400 MM to 3000 MM

**LENGTH :**  
1200 MM to 2250 MM

**KELLY BOX :**  
130x130, 150x150, 200x200 MM



# HEAVY DUTY TOOLS

## SB-HD

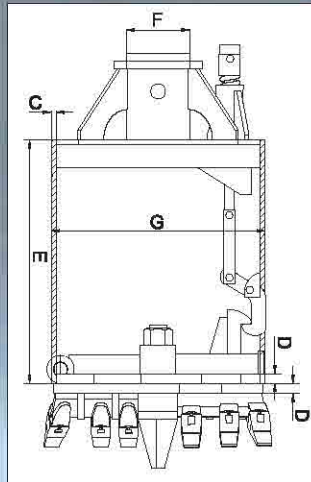
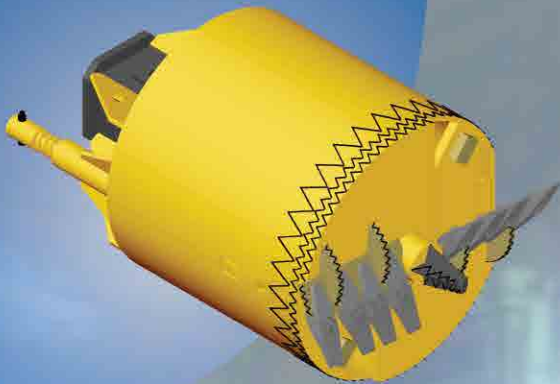

### Features :

- T25 / V19 Soil Teeth
- Double Cutting Edge
- Hard Faced with 650BHN Electrode

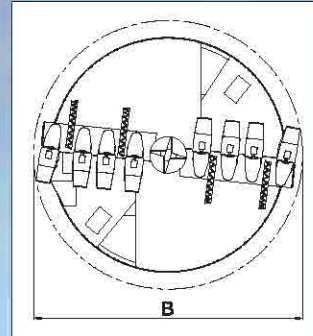

## RB-HD

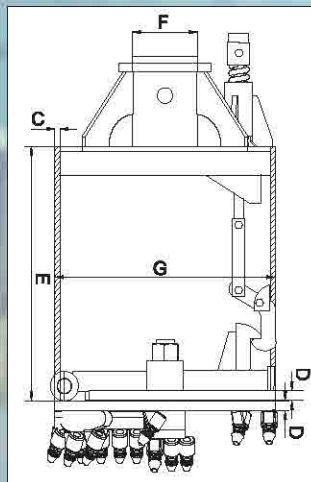

### Features :

- KM-31 / KM-47 Bullet Teeth
- Double Cutting Edge
- Hard Faced with 650BHN Electrode

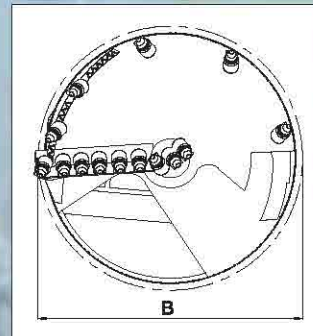

## CB-HD

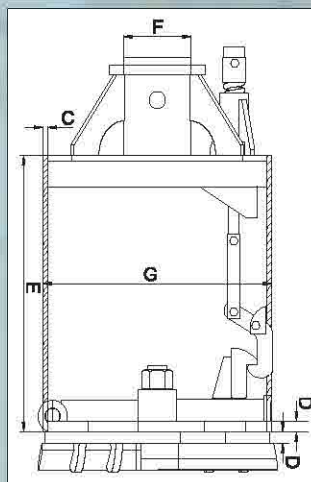
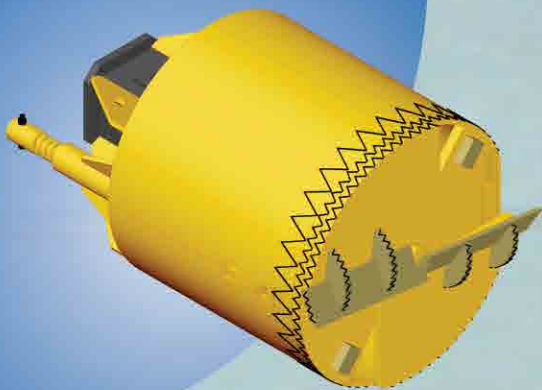

### Features :

- Double Cutting Edge
- Hard Faced with 650BHN Electrode

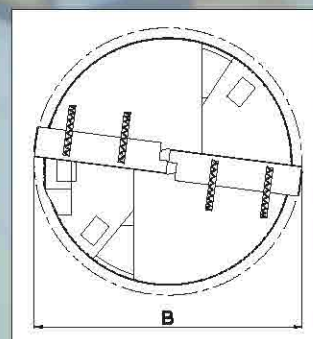

**DIAMETER :**  
400 MM to 3000 MM

**LENGTH :**  
1200 MM to 2250 MM

**KELLY BOX :**  
130x130, 150x150, 200x200 MM



# HEAVY DUTY TOOLS

Table for **SB-HD, RB-HD, CB-HD**

A	B	C	D	E	F
PILE DIA (MM)	CUTTING DIA (MM)	SHELL THICKNESS (MM)	BASE THICKNESS (MM)	SHELL LENGTH (MM)	KELLY SIZE (MM)
500	470	16	40 + 40	1000	AS REQD
600	570	16	40 + 40	1000	AS REQD
700	670	16	40 + 40	1000	AS REQD
750	720	20	40 + 40	1000	AS REQD
800	770	20	40 + 40	1000	AS REQD
900	870	20	40 + 40	1000	AS REQD
1000	970	20	40 + 40	1000	AS REQD
1100	1070	20	40 + 40	1000	AS REQD
1200	1170	20	40 + 40	1000	AS REQD
1300	1270	20	40 + 40	1000	AS REQD
1400	1370	20	40 + 40	1000	AS REQD
1500	1470	25	40 + 40	1000	AS REQD

## CR-HD

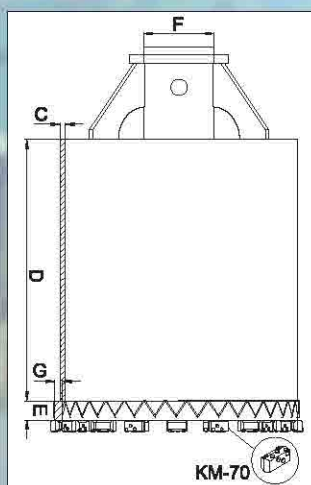

### Features :

- KM-31 / KM-47 Bullet Teeth
- KM-50, KM-55, KM-70  
Teeth Welding Bar
- Hard Faced with 650BHN Electrode

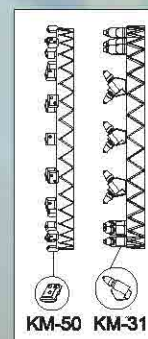
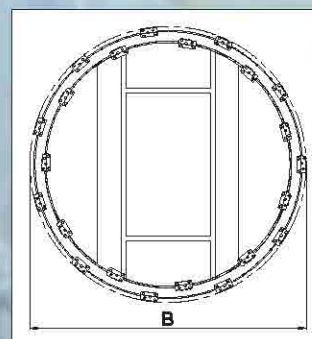

Table for **CR-HD**

A	B	C	D	E	F
PILE DIA (MM)	CUTTING DIA (MM)	SHELL THICKNESS (MM)	SHELL LENGTH (MM)	CORE LENGTH (MM)	KELLY SIZE (MM)
500	470	16	1000	150	AS REQD
600	570	16	1000	150	AS REQD
700	670	16	1000	150	AS REQD
750	720	20	1000	150	AS REQD
800	770	20	1000	150	AS REQD
900	870	20	1000	150	AS REQD
1000	970	20	1000	150	AS REQD
1100	1070	20	1000	150	AS REQD
1200	1170	20	1000	150	AS REQD
1300	1270	20	1000	150	AS REQD
1400	1370	20	1000	150	AS REQD
1500	1470	25	1000	150	AS REQD

**DIAMETER :**  
400 MM to 3000 MM

**LENGTH :**  
1200 MM to 2250 MM

**KELLY BOX :**  
130x130, 150x150, 200x200 MM



# SINGLE START AUGER SUPER HEAVY DUTY

## SA-H1

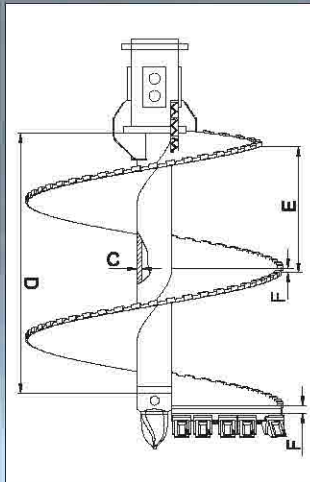
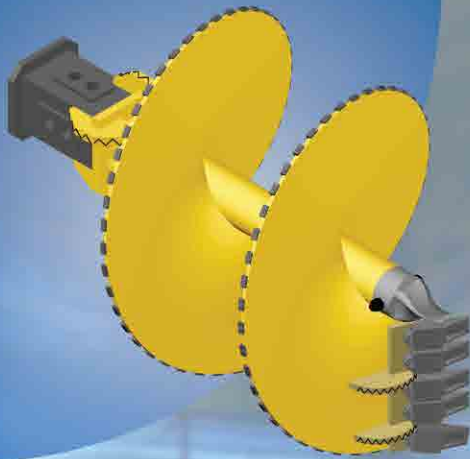

### Features :

- Fish Tail Pilot (H)
- Wear Angle Plate
- Single Cutting Edge
- Flat KM-80 / KM-72 Teeth (G)

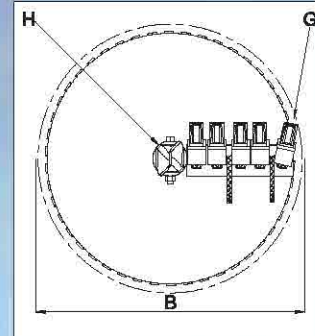

## SA-HK1

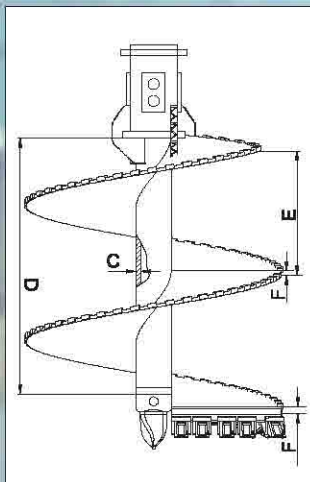
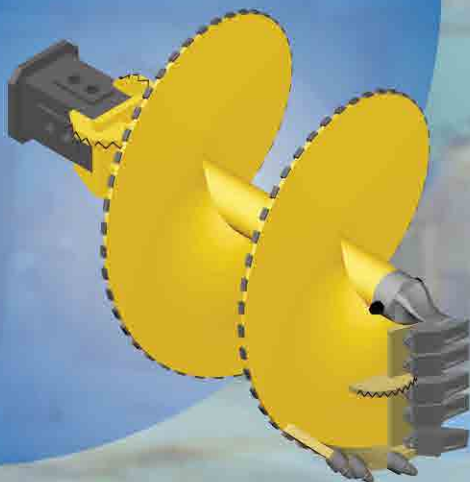

### Features :

- Fish Tail Pilot (H)
- Single Cutting Edge
- Flat KM-80 / KM-72 Teeth (G)
- Cutting Edge with KM47-22HD Bullet & KM-85H Holder (I)

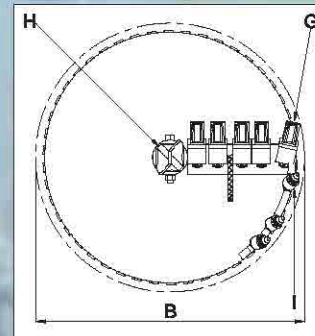

## RA-H1

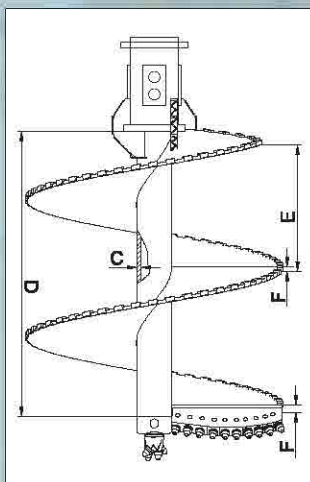

### Features :

- KM-4 Pilot (H)
- Wear Angle Plate
- Single Cutting Edge
- Wedge Plate with KM47-22HD Bullet (G)

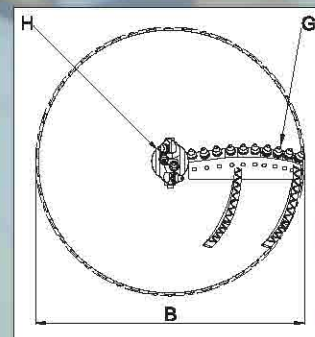

**DIAMETER :**  
400 MM to 3000 MM

**LENGTH :**  
1200 MM to 2250 MM

**KELLY BOX :**  
130x130, 150x150, 200x200 MM



## DOUBLE START AUGER SUPER HEAVY DUTY

### RA-HK2

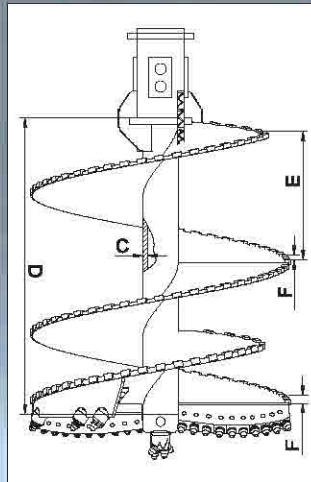

#### Features :

- KM 4 Pilot (H)
- Double Cutting Edge
- Wedge Plate with KM47-22HD Bullet (G)
- Cutting Edge with KM47-22HD Bullet & KM-85H Holder (I)

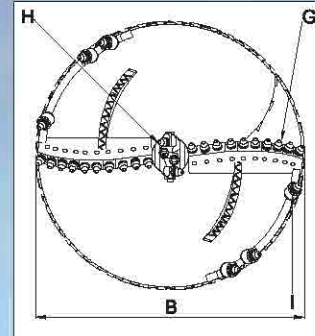

### RA-HC2

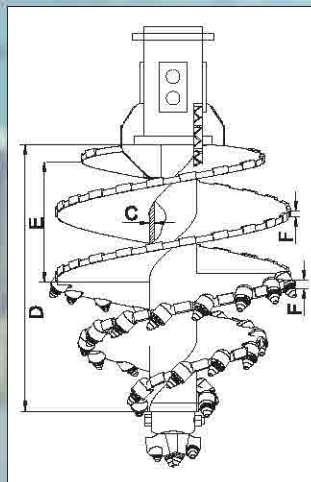

#### Features :

- Progressive Shape
- KM 4 Pilot (H)
- Wear Angle Plate
- Double Cutting Edge
- KM47-22HD Bullet & KM-85H Holder (G)

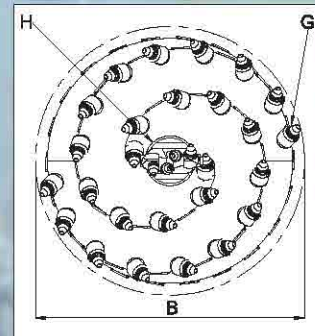

Table for SA-H2, SA-HK2, RA-H2, RA-HK2, RA-HC2

A	B	C	D	E	F
PILE DIA (MM)	CUTTING DIA (MM)	SHELL THICKNESS (MM)	SHELL LENGTH (MM)	PITCH LENGTH (MM)	FLIGHT THICKNESS (MM)
600	570	25	1200	300 + 500	40 + 28
700	670	25	1200	300 + 500	40 + 28
750	720	25	1200	300 + 500	40 + 28
800	770	25	1200	300 + 500	40 + 28
900	870	25	1200	300 + 500	40 + 28
1000	970	25	1200	400 + 600	40 + 28
1050	1020	25	1200	400 + 600	40 + 28
1200	1170	25	1200	400 + 600	40 + 28
1300	1270	32	1200	400 + 600	40 + 28
1500	1470	32	1200	400 + 600	40 + 28
1800	1770	32	1200	400 + 600	40 + 28
2000	1970	32	1200	400 + 600	40 + 28
2200	2170	32	1200	400 + 600	40 + 28
2500	2470	32	1200	400 + 600	50 + 28

**DIAMETER :**  
400 MM to 3000 MM

**LENGTH :**  
1200 MM to 2250 MM

**KELLY BOX :**  
130x130, 150x150, 200x200 MM



# DRILLING BUCKET SINGLE EDGE SUPER HEAVY DUTY

## SB-H1

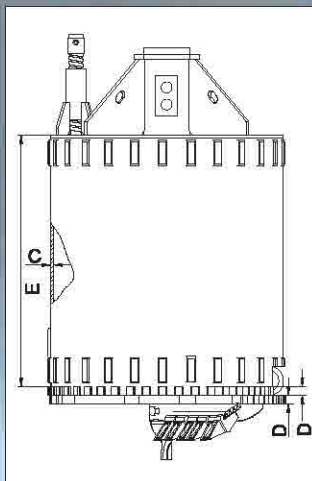

### Features :

- Fish Tail Pilot (F)
- Flat Teeth KM-80/KM-72 Teeth (G)
- Vent Pipe
- Wear Strip
- Single Cutting Edge

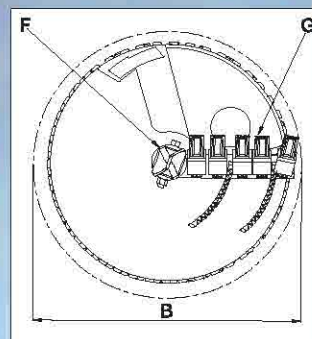

## SB-HK1

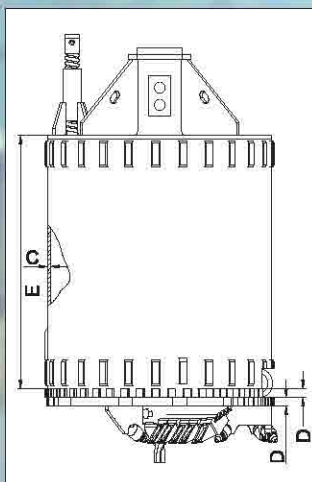
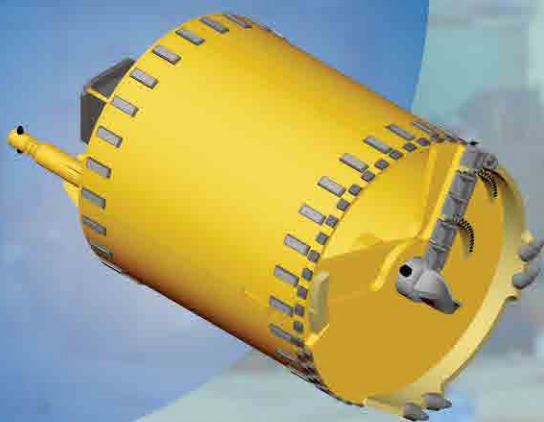

### Features :

- Fish Tail Pilot (F)
- Wear Strip
- Flat Teeth KM-80/KM-72 Teeth (G)
- Single Cutting Edge
- Vent Pipe
- Cutting Edge with KM47-22HD Bullet & KM-85H Holder (H)

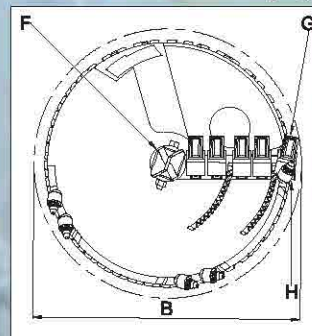

## RB-H1

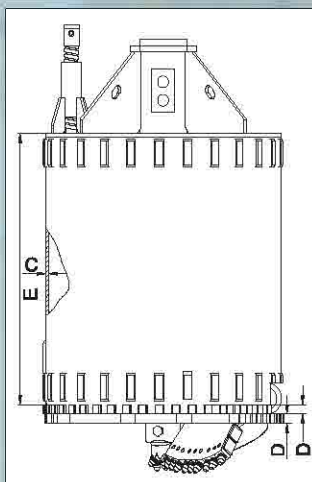
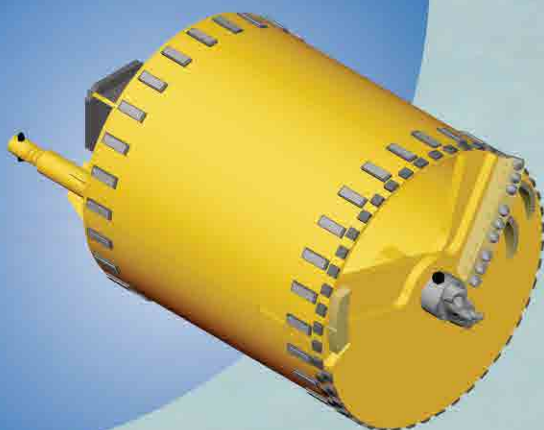

### Features :

- KM 4 Pilot (F)
- Wedge plate with KM47-22HD Bullet (G)
- Wear Strip
- Single Cutting Edge

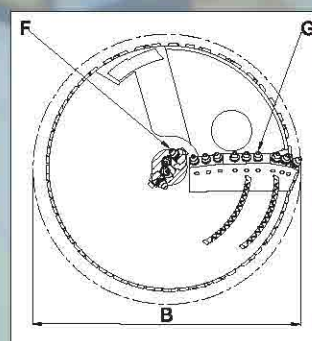

**DIAMETER :**  
400 MM to 3000 MM

**LENGTH :**  
1200 MM to 2250 MM

**KELLY BOX :**  
130x130, 150x150, 200x200 MM



# SINGLE START AUGER SUPER HEAVY DUTY

## RA-HK1

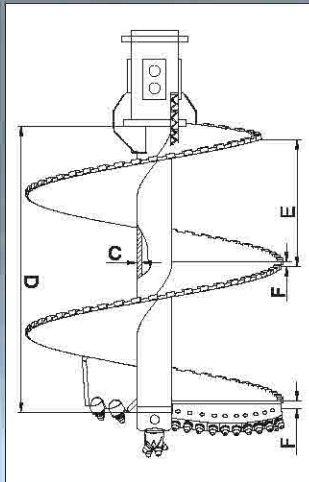

- Features :**
- Single Cutting Edge
  - KM-4 Pilot (H)
  - Wear Angle Plate
  - Cutting Edge with KM47-22HD Bullet & KM-85H Holder (I)
  - Wedge Plate with KM47-22HD Bullet (G)

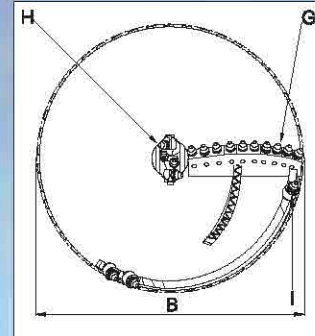

## RA-HC1

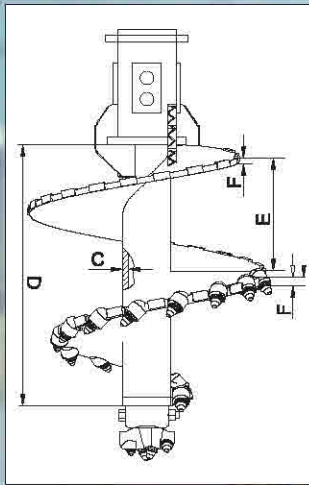

- Features :**
- Progressive Shape
  - KM 4 Pilot (H)
  - Wear Angle Plate
  - Single Cutting Edge
  - KM47-22HD Bullet & KM-85H Holder (G)

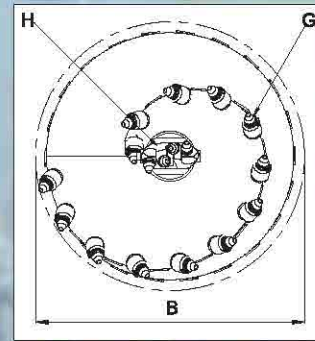

Table for SA-H1, SA-HK1, RA-H1, RA-HK1, RA-HC1

A	B	C	D	E	F
PILE DIA (MM)	CUTTING DIA (MM)	SHELL THICKNESS (MM)	SHELL LENGTH (MM)	PITCH LENGTH (MM)	FLIGHT THICKNESS (MM)
600	570	25	1200	500	40 + 28
700	670	25	1200	500	40 + 28
750	720	25	1200	500	40 + 28
800	770	25	1200	500	40 + 28
900	870	25	1200	500	40 + 28
1000	970	25	1200	600	40 + 28
1050	1020	25	1200	600	40 + 28
1200	1170	25	1200	600	40 + 28
1300	1270	32	1200	600	40 + 28
1500	1470	32	1200	800	40 + 28
1800	1770	32	1200	800	40 + 28
2000	1970	32	1200	800	50 + 28
2200	2170	32	1200	800	50 + 28
2500	2470	32	1200	800	50 + 28

**DIAMETER :**  
400 MM to 3000 MM

**LENGTH :**  
1200 MM to 2250 MM

**KELLY BOX :**  
130x130, 150x150, 200x200 MM



# DOUBLE START AUGER SUPER HEAVY DUTY

## SA-H2

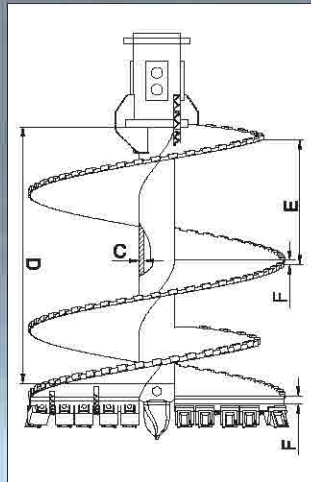
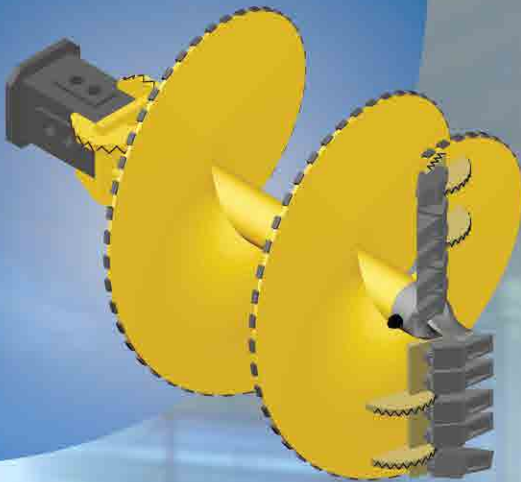

### Features :

- Flat KM-80 / KM-72 Teeth (G)
- Fish Tail Pilot (H)
- Wear Angle Plate
- Double Cutting Edge

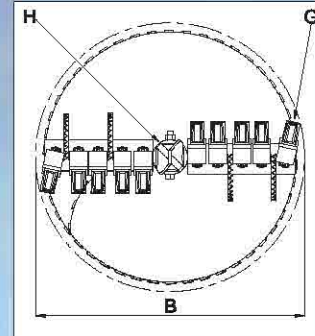

## SA-HK2

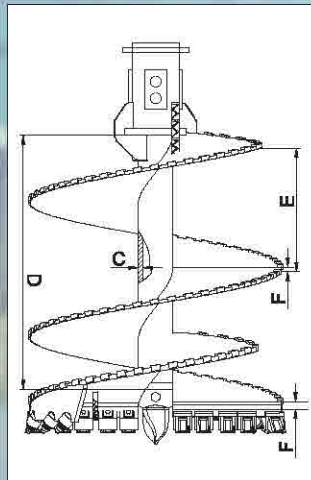

### Features :

- Fish Tail Pilot (H)
- Wear Angle Plate
- Flat KM-80 / KM-72 Teeth (G)
- Cutting Edge WITH KM47-22HD Bullet & KM-85H Holder (I)
- Double Cutting Edge

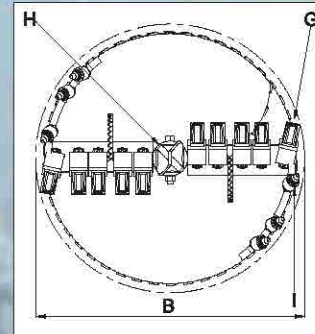

## RA-H2

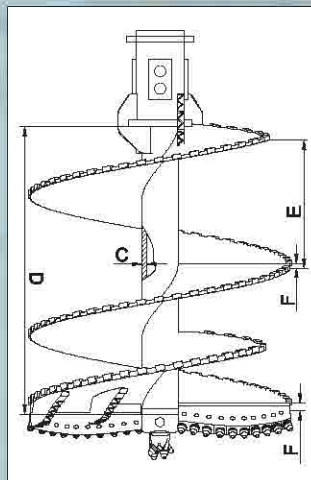

### Features :

- KM 4 Pilot (H)
- Wear Angle Plate
- Double Cutting Edge
- Wedge Plate with KM47-22HD Bullet (G)

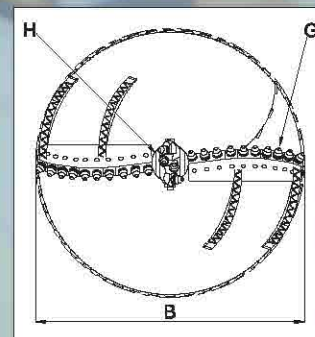

**DIAMETER :**  
400 MM to 3000 MM

**LENGTH :**  
1200 MM to 2250 MM

**KELLY BOX :**  
130x130, 150x150, 200x200 MM



# DRILLING BUCKET DOUBLE EDGE SUPER HEAVY DUTY

## RB-HK2

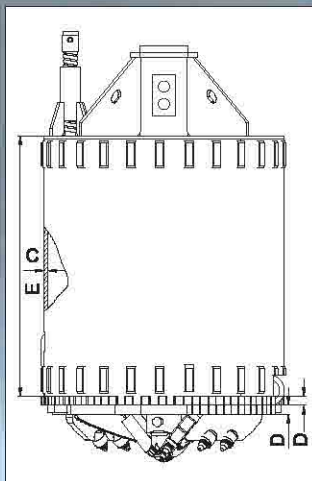
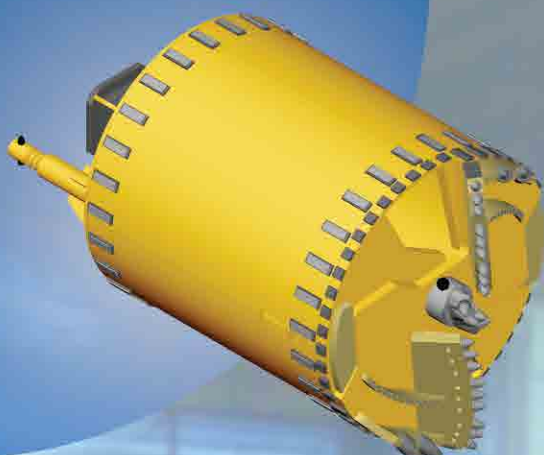

### Features :

- KM 4 Pilot (F) ● Double Cutting Edge
- Wedge plate with KM47-22HD Bullet (G)
- Cutting Edge WITH KM47-22HD Bullet & KM-85H Holder (H) ● Wear Strip

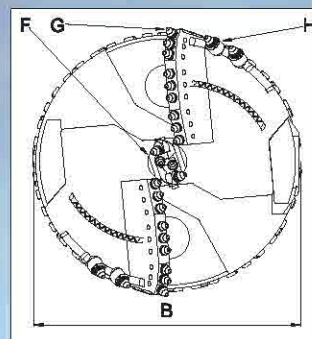

## CB-H2

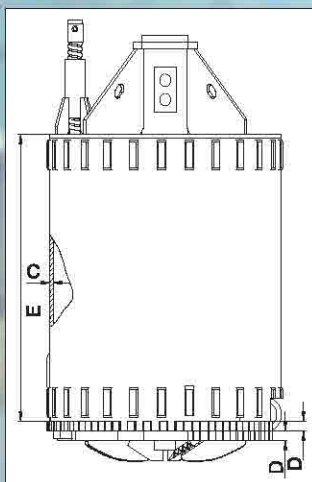
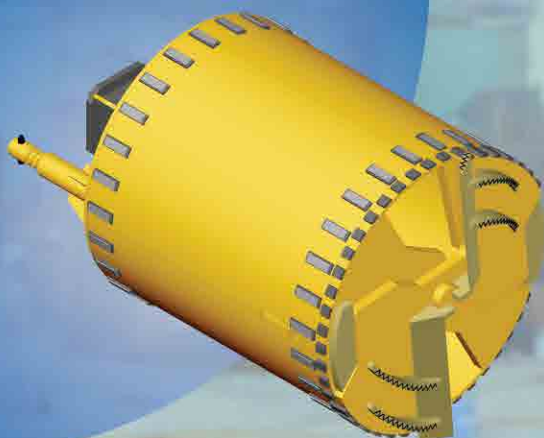

### Features :

- Cutting Edge Designed As Continuous Cleaning Edge
- Wear Strip ● Vent Pipe
- Double Cutting Edge

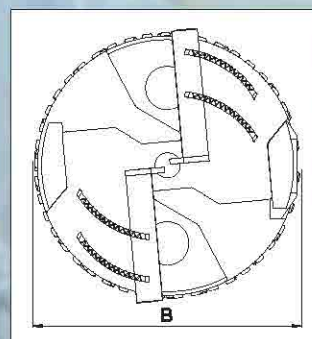

Table for **SB-H2, SB-HK2, RB-H2, RB-HK2, CB-H2**

A PILE DIA (MM)	B CUTTING DIA (MM)	C SHELL THICKNESS (MM)	D BASE THICKNESS (MM)	E SHELL LENGTH (MM)
600	570	16	40 + 40	1200
700	670	20	40 + 40	1200
750	720	20	40 + 40	1200
800	770	20	40 + 40	1200
900	870	20	40 + 40	1200
1000	970	20	40 + 40	1200
1050	1020	20	40 + 40	1200
1200	1170	20	40 + 40	1200
1300	1270	20	40 + 40	1200
1500	1470	25	40 + 40	1200
1800	1770	25	50 + 50	1000
2000	1970	25	50 + 50	1000
2200	2170	25	50 + 50	1000
2500	2470	25	50 + 50	1000

**DIAMETER :**  
400 MM to 3000 MM

**LENGTH :**  
1200 MM to 2250 MM

**KELLY BOX :**  
130x130, 150x150, 200x200 MM



# **DRILLING BUCKET SINGLE EDGE SUPER HEAVY DUTY**

## **RB-HK 1**

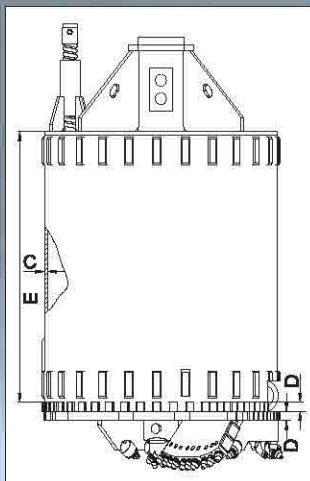

### **Features :**

- KM 4 Pilot (F)
- Wedge plate with KM47-22HD Bullet (G)
- Cutting Edge WITH KM47-22HD Bullet & KM-85H Holder (H)
- Wear Strip ● Single Cutting Edge

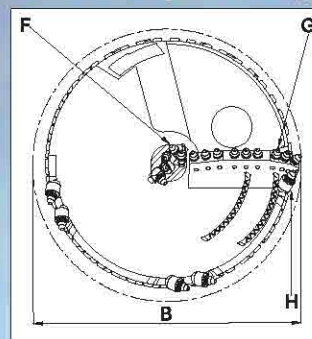

## **CB-H 1**

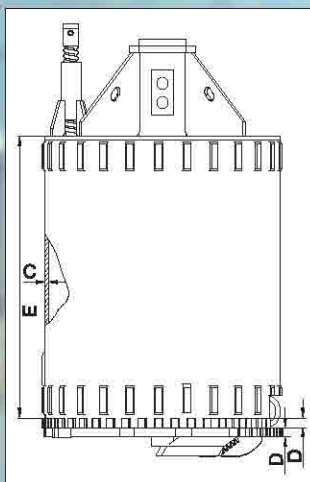
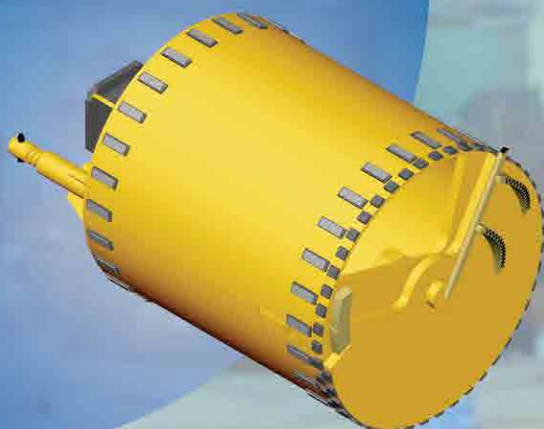

### **Features :**

- Cutting Edge Designed As Continuous Cleaning Edge
- Wear Strip ● Vent Pipe
- Single Cutting Edge

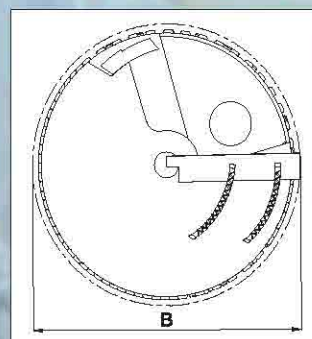

**Table for SB-H1, SB-HK1, RB-H1, RB-HK1, CB-H1**

A PILE DIA (MM)	B CUTTING DIA (MM)	C SHELL THICKNESS (MM)	D BASE THICKNESS (MM)	E SHELL LENGTH (MM)
600	570	16	40 + 40	1200
700	670	20	40 + 40	1200
750	720	20	40 + 40	1200
800	770	20	40 + 40	1200
900	870	20	40 + 40	1200
1000	970	20	40 + 40	1200
1050	1020	20	40 + 40	1200
1200	1170	20	40 + 40	1200
1300	1270	20	40 + 40	1200
1500	1470	25	40 + 40	1200
1800	1770	25	50 + 50	1000
2000	1970	25	50 + 50	1000
2200	2170	25	50 + 50	1000
2500	2470	25	50 + 50	1000

**DIAMETER :**  
400 MM to 3000 MM

**LENGTH :**  
1200 MM to 2250 MM

**KELLY BOX :**  
130x130, 150x150, 200x200 MM



# DRILLING BUCKET DOUBLE EDGE SUPER HEAVY DUTY

## SB-H2

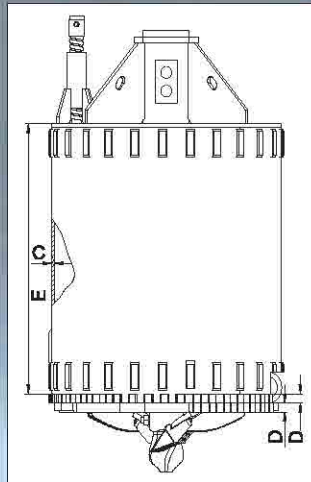
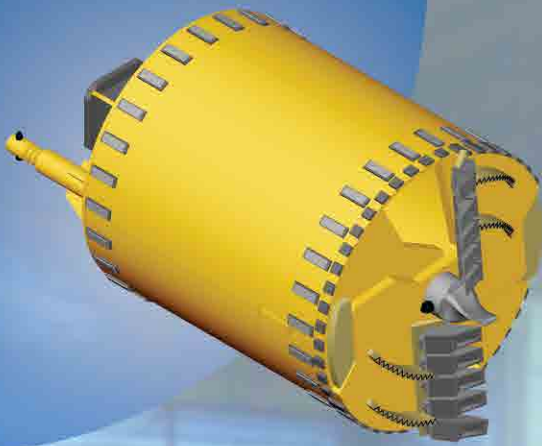

### Features :

- Fish Tail Pilot (F)
- Flat Teeth KM-80/KM-72 Teeth (G)
- Vent Pipe
- Wear Strip
- Double Cutting Edge

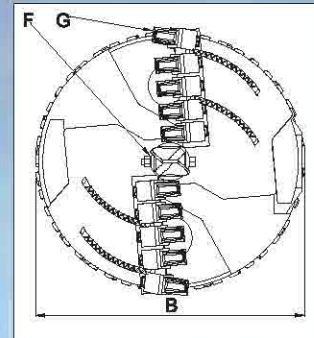

## SB-HK2

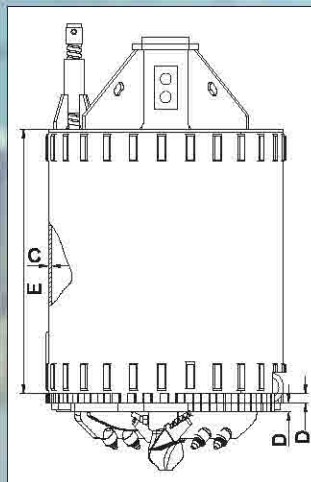

### Features :

- Fish Tail Pilot (F)
- Wear Strip
- Flat Teeth KM-80/KM-72 Teeth (G)
- Double Cutting Edge
- Vent Pipe
- Cutting Edge with KM47-22HD Bullet & KM-85H Holder (H)

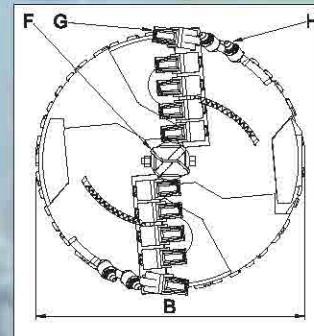

## RB-H2

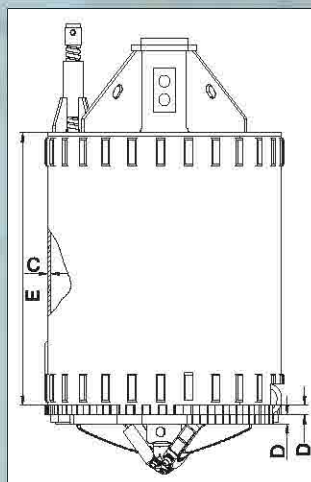
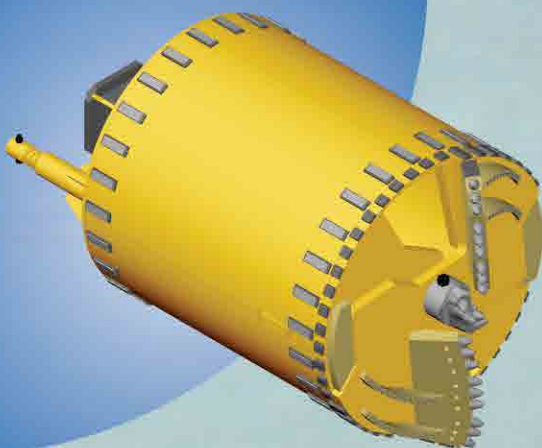

### Features :

- KM 4 Pilot (F)
- Wedge plate with KM47-22HD Bullet (G)
- Wear Strip
- Double Cutting Edge

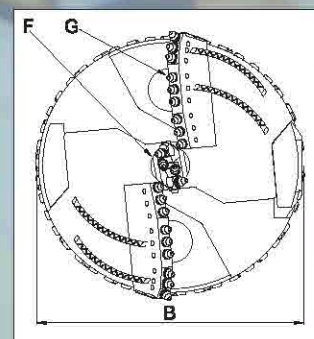

**DIAMETER :**  
400 MM to 3000 MM

**LENGTH :**  
1200 MM to 2250 MM

**KELLY BOX :**  
130x130, 150x150, 200x200 MM



# SUPER HEAVY DUTY CORE BARREL

## CR-HB

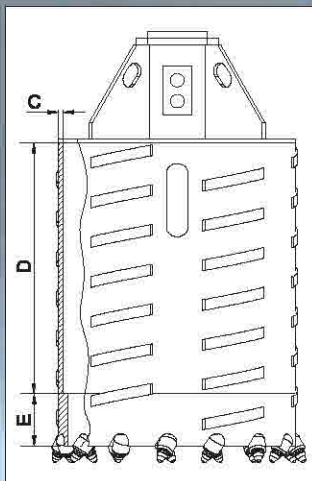

### Features :

- KM47-22HD Bullet & KM-85H Holder (F)
- Wear Strips

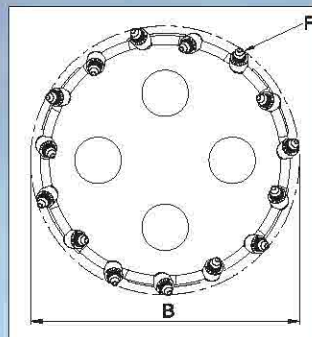

## CR-H2

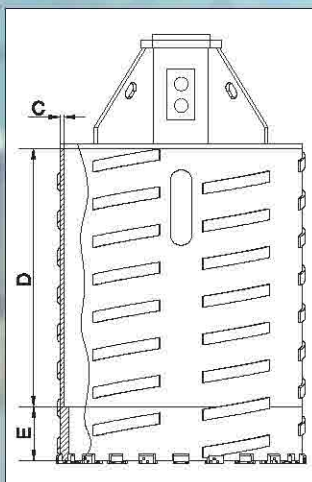

### Features :

- KM-50, KM-55, KM-70 Teeth (WELDING BAR) (F)
- Wear Strips

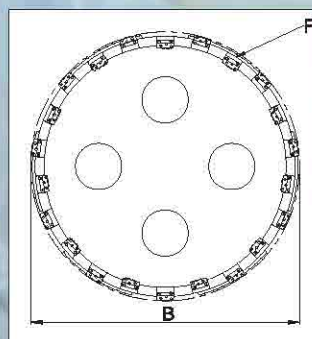

## CR-HBX

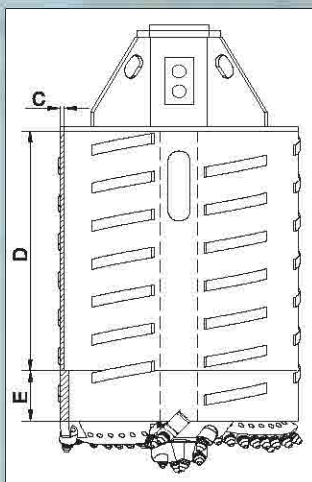

### Features :

- Wedge plate with KM47-22HD Bullet (F)
- Cutting Edge with KM47-22HD Bullet & KM-85H Holder (G)
- KM 4 Pilot (H)

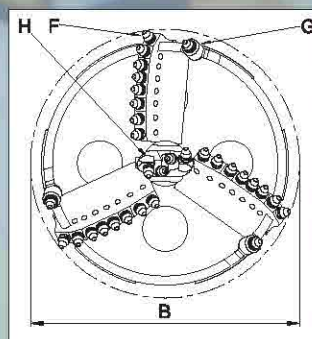

**DIAMETER :**  
400 MM to 3000 MM

**LENGTH :**  
1200 MM to 2250 MM

**KELLY BOX :**  
130x130, 150x150, 200x200 MM



## SUPER HEAVY DUTY CORE BARREL

### CR-H2R

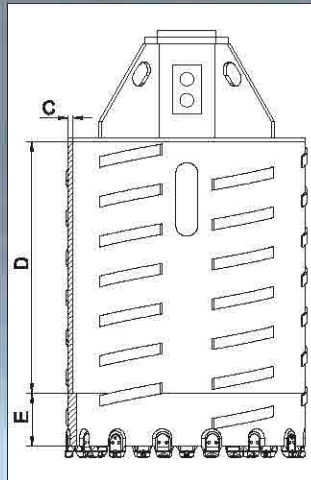

#### Features :

- KM-39 Replaceable Teeth (F)
- Wear Strips

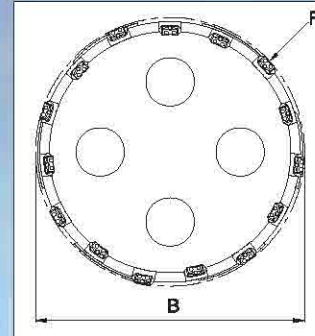

### CR-HRM

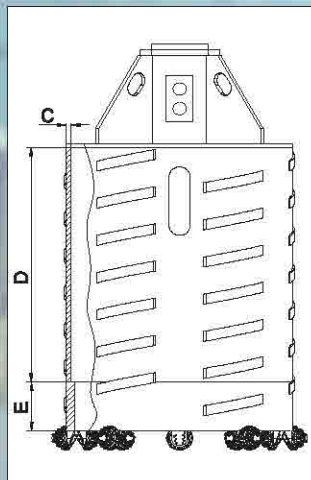

#### Features :

- Roller Bits (F)
- Wear Plates
- Used To Cut Rock Above 80 Mpa.

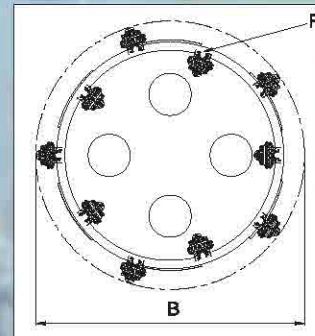

Table for **CR-HB, CR-H2, CR-HBX, CR-H2R, CR-HRM**

A PILE DIA (MM)	B CUTTING DIA (MM)	C SHELL THICKNESS (MM)	D SHELL LENGTH (MM)	E CORE LENGTH (MM)
600	570	16	1200	250
700	670	20	1200	250
750	720	20	1200	250
800	770	20	1200	250
900	870	20	1200	250
1000	970	20	1200	250
1050	1020	20	1200	250
1200	1170	20	1200	250
1300	1270	20	1200	250
1500	1470	25	1200	250
1800	1770	25	1000	250
2000	1970	25	1000	250
2200	2170	25	1000	250
2500	2470	25	1000	250

**DIAMETER :**  
400 MM to 3000 MM

**LENGTH :**  
1200 MM to 2250 MM

**KELLY BOX :**  
130x130, 150x150, 200x200 MM



# BIG DIA TOOLS

Upto 3000 MM



**Aiming to satisfy our clients with our qualitative product range.  
We offer a range of Drilling tools.**



# AUGER



- Kamar augers are manufactured in various models to accomplish the requirements for every type of ground drilling conditions.
- In order to increase the resistance of our augers, special compound steels are used on request.
- The Kelly boxes can be manufactured custom sized and shaped for every kind of drilling rigs.
- On request, every type of hard-facing & ware protection is available. We can also use special wear protection plates and sheets.
- We prefer to use our own well-known branded carbide picks and teeth.
- For soil conditions, long attack, high penetration ability special excavation type teeth and tungsten carbide inserts protected teeth options are available as per the requirements.



# BUCKETS



- Kamar buckets are designed to show the best performance at every relevant ground conditions.
- Special interior designs for easy unloading operation.
- The Kelly boxes can be manufactured, custom sized and shaped for every kind of drilling rigs.
- Bottom blades and Kelly boxes are made of high quality steel to assure the longest living of the tool.
- On request, every type of hard-facing and ware protection are available.
- Although our products are based on two different models, on request, custom types can be manufactured. The equipment is composed by teeth or changeable picks, in both cases dimensions are defined according to the geological nature of the soil and to the machine torque. All the parts merely subject to abrasion are welded to hard face ribbing.



## CORE BARREL



- Our core barrels have long lifetime by our choice of special steel alloys and welding techniques.
- We are specialized in manufacturing a fine quality range of core barrel cutting rings which are featured with KM47-22 HD bullets, KM-85 Holder, Welding bars, Roller bits and wear strips. These products are highly appreciated for their cost effectiveness and these products are manufactured using superior quality raw materials obtained from reliable vendors. Our products are having competence as well as effectiveness and are used in different industries.
- The Kelly boxes can be manufactured custom sized and shaped for every kind of drilling rigs.
- On request, every type of hard-facing and ware protection are available.
- Although our standard products are based on two different models, on request, custom types can be manufactured.



# WEAR PARTS

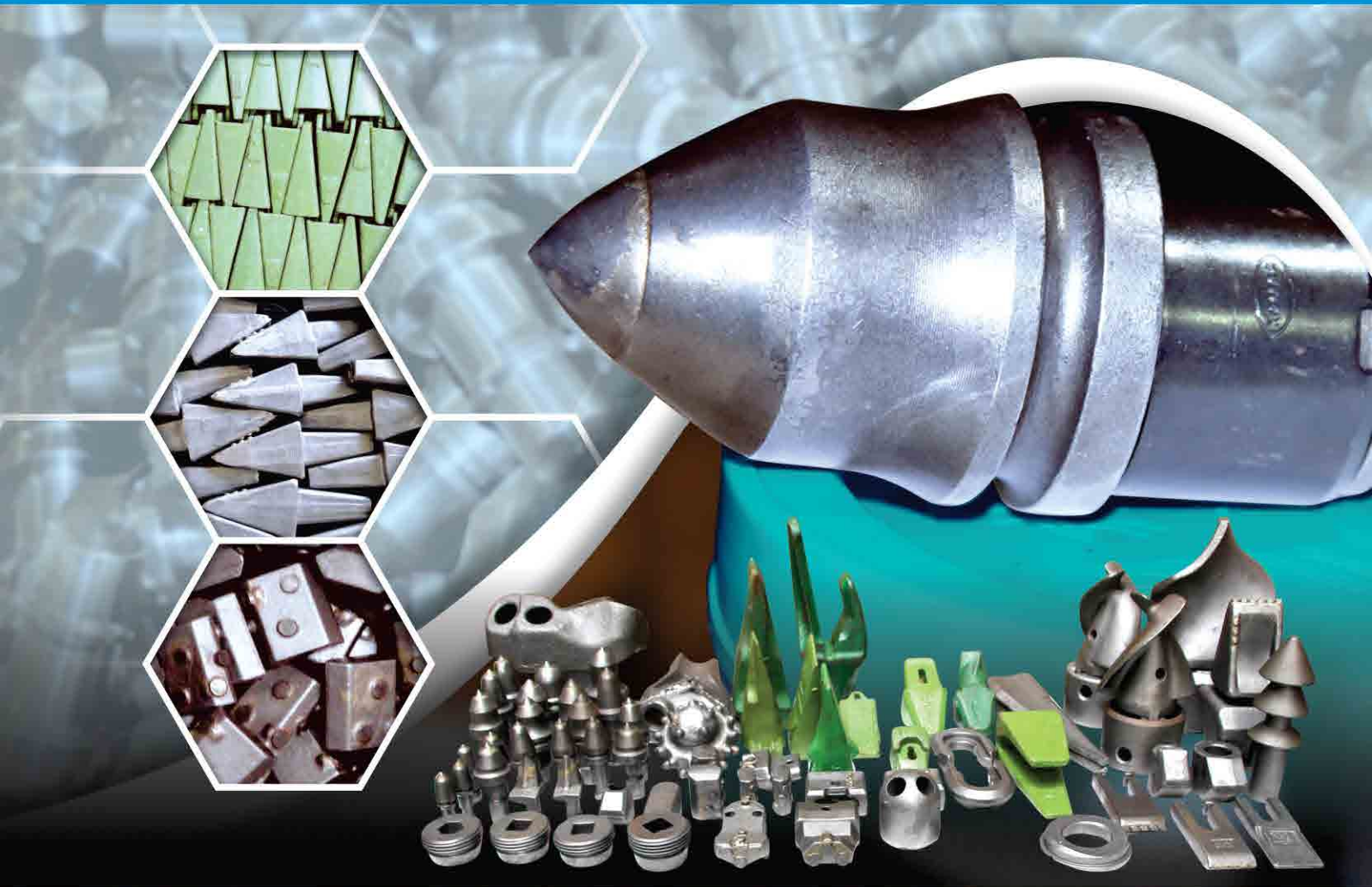

Kamar Infrastructure is a professional manufacturer & exporter of road milling tools, foundation drilling tools, Coal milling tools & rock drilling tools used for tunneling, trenching, drilling & coal excavating. Having a vast experience in the field, we have created a strong good will among our customers.

We manufacture a superior quality range of wear part, which are used for foundation drilling works, we offer these products in varied specifications. Our products having reliability, efficiency and robustness and we manufacture these products using state of art technologies using latest machines. In addition, these products are available to fulfill the client's requirement.

Backed by strong technical & production experience we are able to deliver the best tools of superior quality and service to meet your request.

As a producer of road mining picks we offer high wear & impact resistance for milling asphalt & concrete road to various depths. Our tungsten carbide picks offer improved wear resistance as well as outstanding fracture tougher characteristic.

Kamar offers a full range of tools & tooling system for mining. Our in-house production facility gives us an edge to deliver economical products & timely delivery ensuring the highest quality of products past.

We offer round shank with insert from 8 to 30 mm and shaft diameters from 10 to 38 mm. a full range of head design, retainer system and inserts is available for your specific requirements. Customized picks can be manufactured upon request.

Drill bits are available for blast hole drilling, roof bolting and exploration in diameter from 24 mm to 150 mm with all common use threads. In general our drill bits are equipped with tungsten carbide inserts. For very abrasive rock conditions we recommend our drill bits with polycrystalline insert. Kamar possess high-tech modern machine & manufacturing ability ensuring timely production with superior quality.



# WEAR PARTS MANUFACTURING

## FORGE SHOP



**Kamar Uses The Latest Technology In Forging To Produce The Highest Quality Products At Economical Cost.**





# WEAR PARTS MANUFACTURING

## MACHINE MALL



Kamar uses the modern machining technology to machine parts with highest precisions various CNC turning centers. Including fully automated dual turret lathes machine parts from stock up to four inch in diameter. Larger diameter parts can easily be accommodated in our CNC & VMC Lathe. We also utilize several six and eight spindle screw machine with capacities up to 23.1/4 inches in diameter. Our vertical and horizontal CNC machine center is equipped with multiple pallets large enough to machine parts in excess of 300 Lbs. We also have various secondary lathe, Mills and drill presses.





# WEAR PARTS

## BULLETS, TEETH & HOLDERS



**KM-18T**



**KM-18TH**



**KM-25T**



**KM-25TH**



**KM-V19**



**KM-V19T**



**KM-31HD**



**KM47-22HD**



**KM-CS7**



**KM-30H**



**KM-43H**



**KM-85H**



**KM-80**



**KM-72**



**KM-39**

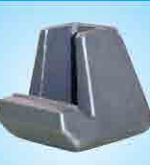

**KM-80H**



**KM-72H**



**KM-39H**



**KM-65(9.2)**



**KM-65H**



**KM-80-33/20**



**KM-60/20**



**KM-50**



**KM-55**



**KM-70**



**FISH TAIL PILOT**



**KM4 PILOT**



**PILOT HOLDER**



**ROLLER BIT**



**PIN & LOCKS**



**CASING PARTS**



**CUTTING WHEELS CUTTERS**



**KELLY PIN & LOCKS**



**CUTTING WHEELS PICKS**

### Main Features

- High durability due to wear-resistant tempered steel
- High grade tungsten carbide tip
- Excellent rotation and secure seating due to a clamping sleeve
- High degree of solder quality
- Extraction groove for easy tooth replacement

### Tooth holder

The tooth holders are optimally adapted to the different types of round shank chisels. Rear ejector port facilitates easy tooth replacement. Its compact construction facilitates the execution of complicated cutting geometries and optimal adjustment of tooth position.



# CASING SYSTEM



With wide & rich industrial experience in Casing System. We are able to manufacture, supply and export a wide variety of Casing System. This Casing System is manufactured using high grade raw material that is procured from most reliable vendors.

- Kamar Casings and casing shoes have high resistance and easy montage advantages.
- We use high quality carbide protection teeth for our casing shoes.
- Special metal alloys can be used for the joints.
- Montage can be done in a very short time by using screw ring joints.
- We use unique methods in manufacturing our casings. So, even in case of oscillator usage at the field, performance of the product does not decrease.



# CASING PARTS

## DOUBLE WALL CASING ASSEMBLY WITH 40MM JOINT & 16MM THICKNESS WALL WITH SCREW

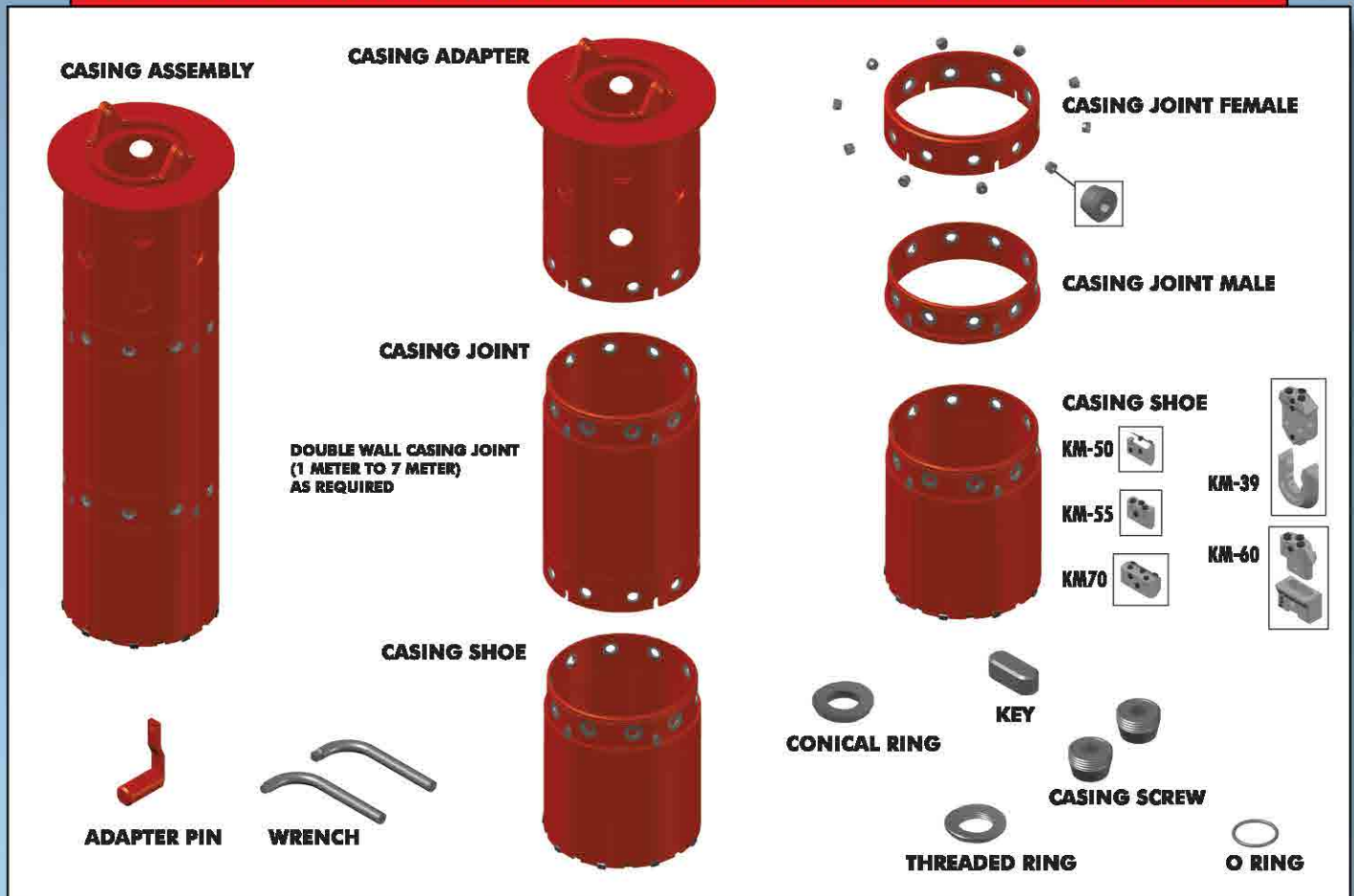



# DESANDER & PUMPS





## KD DESANDER FOR BENTONITE MUD

KD desanders that are manufactured by KAMAR. Are particularly designed to treat Bentonite mud used in drilling and excavating operations with machines equipped with rotating drills or bucket and with forward or reverse circulation. Bentonite mud is treated and washed by separating them from solid polluting matters such as: sands, clays, slimes and organic matters. The first treatment i.e. roughing is carried out on the steel screen whereby parts exceeding 4mm are separated, then mud is stored in the tank and from here it is sucked by the pump and conveyed to the hydro cyclone. Here all particles with granuloma try exceeding

40/50 micron are separated; treated mud flows to a special circuit where a valve keeps the tank level constant to this purpose, if necessary, some mud coming from the hydro cyclone flows back. All elements subject to wear are made of special wear resistant materials that are type selected and tested; all purchased parts are top quality, widely marketed parts that can be easily found on the markets of countries these machines are usually exported to.



### TYPICAL APPLICATION



- Bentonite supported pilling with grabs small diameter drilling for injection and anchors.
- Well drilling occasionally used in combination with tunneling machines.

### TECHNICAL SPECIFICATION

MODEL	KD1500 HP	KD2000 HP
Capacity (m <sup>3</sup> /h)	90	140
Rotation Speed (rpm)	1440	1440
Installed Power (kw)	15	22
Tank Capacity (m <sup>3</sup> )	1.2	1.5
Main Screen (m <sup>2</sup> )	1.0	1.2
Secondary Screen (m <sup>2</sup> )	0.8	1.0
Hydrocyclone	1X280	1X420
Cut Point (d <sub>50</sub> )	45	45
Length (m)	3.4	3.8
Width (m)	1.4	1.5
Weight (Kg)	1850	2200



## KTM MIXERS FOR BENTONITE MUD



**KTM** turbo mixers that are manufactured by **KAMAR** are particularly designed to treat Bentonite mud used in drilling and excavating operations. The **KTM** Turbo mixer consists of a sheet steel cylindrical tank, set up on a strong frame. Muds are mixed through a high speed vortex produced by a special pump which, after sucking from the bottom of the tank, sends them back tangentially into the same tank, shaped in order to get highest efficiency. Through a timely operating of the throttle valves of the system, the pump provides for carrying the muds to the storing container or to the using area. Through this process it's possible to obtain homogeneous colloidal and high quality mixture in a short time.

### TYPICAL APPLICATION

- Bentonite supported pilling with grabs small diameter drilling for injection and anchors.
- Well drilling occasionally used in combination with tunneling machines.

### TECHNICAL SPECIFICATION

MODEL	KTM1000	KTM1500
Tank Capacity (m3)	1.2	1.8
Output (m3/h)	12/15	15/18
Pump Delivery (m3/h)	200	200
Electric Motor (Kw)	11	11
Length (m)	2.4	2.4
Width (m)	1.8	1.8
Height (m)	1.2	1.4
Weight (Kg)	800	900



## WELLPOINT DEWATRING DOUBLE ACTING PISTON PUMP



### Lubrication and drive

Precisely machined drive gears and an automatic lubrication system provide excellent performance and minimal



### Practical valve system

The valve system is fitted with an O-ring seal and a solid bridge section for securing purposes. This allows for quick and easy disassembly, even after prolonged use.

### Easy access points

Allowing access to the cylinders, stuffing boxes and other critical areas for easy cleaning and maintenance.

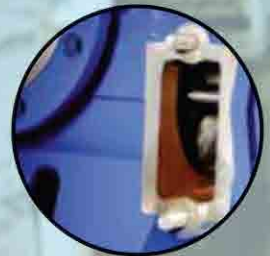

### Hard-wearing piston rods

The stainless steel piston rods have been carefully machined to provide an increased service life and minimal maintenance.



## TECHNICAL SPECIFICATION

MODEL	KPP-600	KPP-900
Cylinder Diameter (mm)	160	175
Number of Cylinders (NOS)	2	2
Installed Engine Power (Kw)	5.5	7.5
Max. Capacity (m <sup>3</sup> /h)	65	95
Max. Head (m)	22	22
Max Vacuum (m)	9.4	9.4
Bare End Pump Weight (Kg)	825	825
Efficiency, up to (%)	92	92
Shaft Sealing	Gland Packing	Gland Packing
Connection (In)	4 and 6	4 and 6



## KVP VERTICAL PUMP

KAMAR VERTICAL PUMPS are basically designed for Construction Industry, for mixing and pumping of Bentonite clay used in pilling work. The Pump has vertical format design, Top Suction, Cantilever Type of Bearing Housings, while the drive motor is located at the top. The design of the pump is such that it mixes as well as it pumps the Bentonite slurry, thus giving the effect of churning the Bentonite Slurry in the tank.

This pump can be hung in the tank by means of chain pulley blocks or any other conventional method so that it can be lowered or raised as per the level of the Bentonite in the tank. Bentonite Mixing Pump is used to mix and pump Bentonite Slurry during the Pilling Process in Construction Industry. The material is such as to withstand the abrasive nature of the slurry during Pilling Process.



### TYPICAL APPLICATION

- Constructions

### TECHNICAL SPECIFICATION

CAPACITY (m3/hr.)	60-108
Head (mts)	15-27
Sp. Gr. of Slurry	1.15
Pump Speed (RPM)	1400
Wear Parts	Hi-Chrome
Discharge dia. (mm)	75
Suction dia (mm)	125
Mounting	Vertical
Absorbed Power (Kw)	10
Motor Rating (Kw)	11
RPM	1450
Frame Size	160 M
Working Pressure (bar)	16





## CENTRIFUGAL WATER PUMP

### CONSTRUCTIONAL FEATURES

Pumps are as per DIN 24256 and ISO 2858 and generally conform to API 610 (7th Edition). The design is to back pull out type. Large variety of models are available to operate at 1450 rpm and 2900 rpm at 50 Hz and 1750 rpm and 3500 rpm at 60 Hz.

#### CASING

The casing has axial suction and top centre line delivery. Smooth hydraulic passages ensure high efficiency. Normal design is for foot mounted pumps. Centre line mounting for special applications are also available.

#### IMPELLER

The impellers are of enclosed type and semi-open impellers can also be supplied. Hydraulic balancing of impellers is achieved either by back vanes or by balancing holes. The impellers are statically and dynamically balanced. Reliable fixing of the impeller on shaft is achieved by using helicoil insert under impeller nut. To improve NPSH performance, inducer can be supplied.

#### SHAFT

The shaft is supported by two antifriction bearing to take Residual Axial Thrust and Prevent Axial Float or Radial Run Out. It is fully protected from the liquid handled by means of a shaft Sleeve and PTFE Gaskets between impeller Nut, Impeller Hub and Shaft Sleeve.

#### STUFFING BOX

The stuffing box is sealed by gland packing or by mechanical seal. Conversion from gland packing to mechanical seal is achieved by changing some standardized parts. Re-machining of stuffing box is not necessary. Stuffing box cooling is provided for high temperature applications.

#### BEARINGS

The bearings are oil lubricated. For high temperature application, bearing oil cooling arrangement is provided.

#### DIRECTION OF ROTATION

Clockwise viewed from driving end.

#### DRIVE

Pumps can be driven by electric motors.

#### FLANGES

##### Standard

Drilling as per ND 16

DIN 2533 (Cast Iron — Raised face)

DIN 2543 (steel-Plain face)



### TYPICAL APPLICATION

- Water treatment & distribution system for Constructions.

CAPACITY (m <sup>3</sup> /hr.)	400
TDH (MLC)	140
Temperature (°C)	120
Working Pressure (Bar)	15



# PILING WINCHES & ACCESSORIES





## WINCHES



We manufacture piling winches made of high quality raw materials & are available in various specifications like 5T, 7.5T & 10T. The number of drums available are 1 or 2 for all types of winches & the wire rope diameter are 25mm, 28mm & 32mm respectively.

### TECHNICAL SPECIFICATIONS

TYPE	5T	7.5T	10T
No. of DRUM	1 OR 2	1 OR 2	1 OR 2
WIRE ROPE	25mm	28mm	28mm
H.P. REQUIRED	65	83	98

Note: We reserve the right of making technical alterations.

## CHISSEL



## BAILER





**A FRAME**



**HAMMERING MONKEY**



**GANTRY WHEEL**



**DMC ROD**





# DIAPHRAGM WALLS GRABS



## **HEAVY DUTY REVOLVING TELESCOPIC KIT FOR DIAPHRAGM WALLS**

Suitable for HR-180 Piling Rig Consisting of

- Square Type Kelly Bar of 3 Elements for 32m Depth.
- 180 Degree Revolving Guide Frame which Revolves by Hydraulic Motor.
- Left & Right Hydraulic Hose Reel.
- Cathead With 4 o's Sheave
- Kelly Bar Guide
- Rectangular Grab Body with Interchangeable Jaws from 600mm to 1000mm.





# STOP END

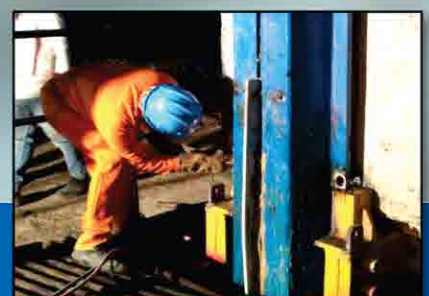
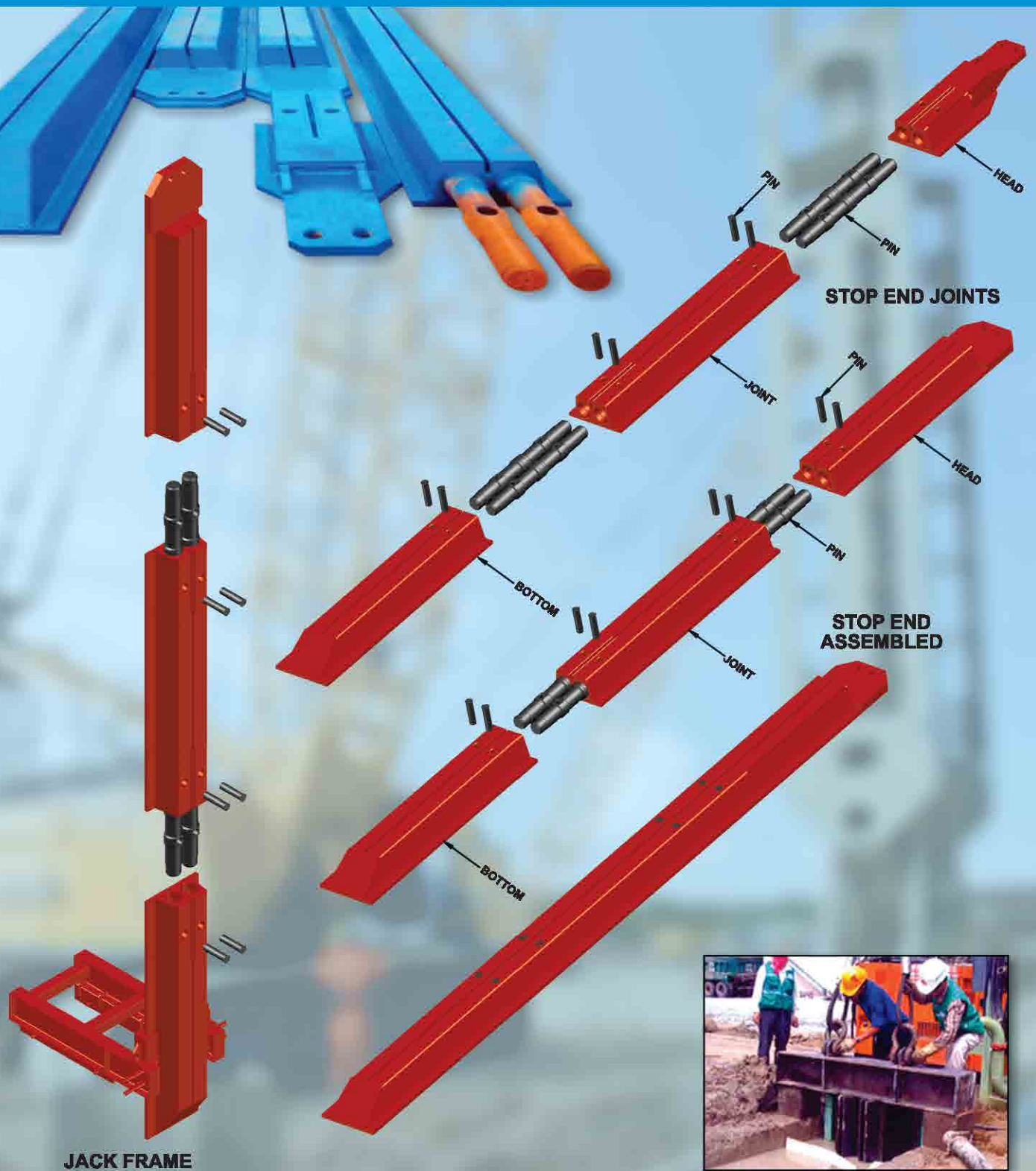



# TREMIE PIPES & ACCESSORIES

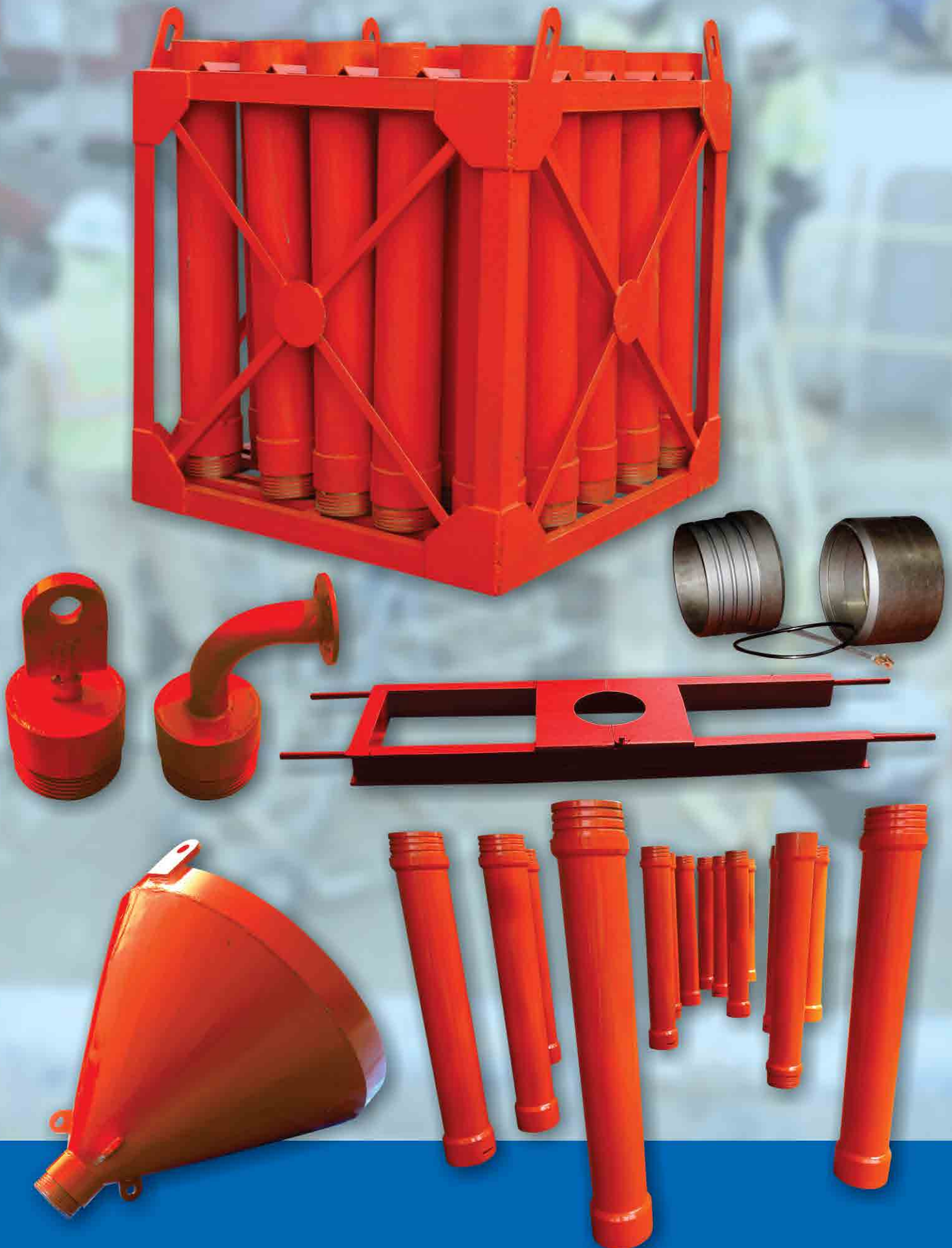



# TREMIE PIPES

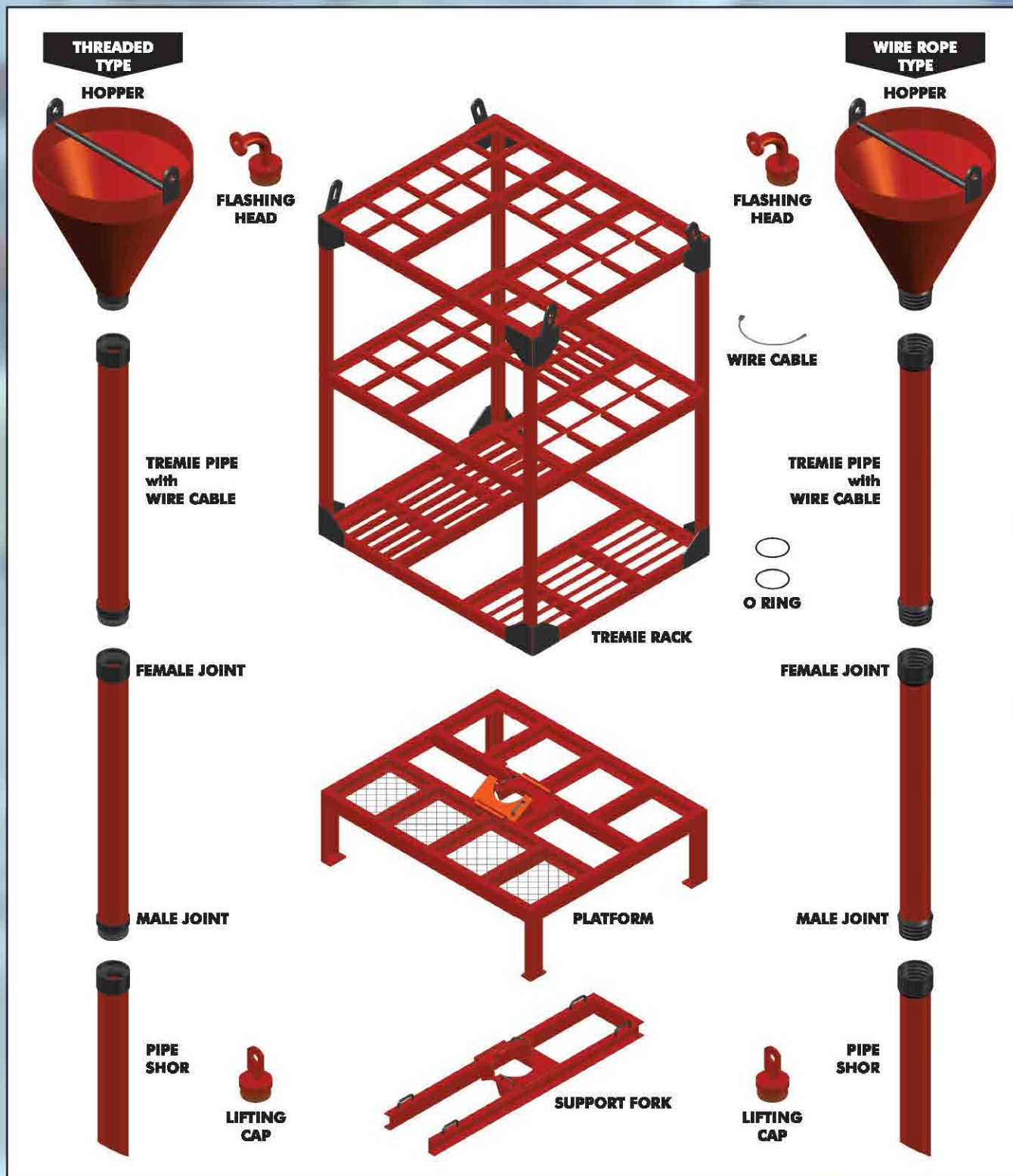



# COUPLERS

## INTRODUCTION



**KAMAR** a producer of a parallel-threaded mechanical splicing system designed for the connection of concrete reinforcing bars 14MM to 50MM.

Taking "Improving the level of foundation construction technology" as our mission and by depending on a group of engineers and skilled workers with years of experience in foundation engineering and construction design, our products have reached the advanced level in INDIA in terms of the technology and quality as well.

With the latest production facilities and factory, we have completed the designs of **Cold forged parallel thread couplers/attachments** and construction methods in many large-scale and complicated foundation projects such as Metro and Monorail which has helped us to win a good reputation among our clients with excellent products and services.

Our efforts to bring forth a world class product range have been leveraged by the support from world class infrastructure. Laced with sophisticated machines and all kinds of amenities, we have been able to deliver our range in bulk well within the limitations of time. Our facility is divided into specialized units like production department, warehouse and packaging department, quality testing laboratory and other units to see through the smooth functioning of our business. Our Infrastructure provides for customization of our product range to comply with the specifications of our clientele.

KAMAR highly focuses on international cooperation and communication. Till present, our products have been exported to many different countries and regions such as Dubai, Singapore, Malaysia, Bangladesh, Iraq, Saudi Arabia, South Africa, Sri Lanka, USA, Australia, etc.





## MANUFACTURING FACILITIES



Kamar uses the modern machining technology to machine parts with highest precisions various CNC turning centers. Including fully automated dual turret lathes machine parts from stock up to four inch in diameter. Larger diameter parts can easily be accommodated in our CNC & VMC Lathe. We also utilize several six and eight spindle screw machine with capacities up to 23.1/4 inches in diameter. Our vertical and horizontal CNC machine center is equipped with multiple pallets large enough to machine parts in excess of 300 Lbs. We also have various secondary lathe, Mills and drill presses.





# MACHINES

## REBAR CUTTING MACHINES



## REBAR THREADING MACHINES



## REBAR FORGING MACHINES





# CONCLUSION

## REASON TO PURCHASE REBAR COUPLERS FROM KAMAR

Using KAMAR Rebar Splicing offers various advantages over the method of overlapping of reinforcement bars. Some of the prime reasons are as follows.

1. Splice rebar performs like continuous reinforcement due to mechanical joint, unlike lapping which has complete dependency on concrete
2. Steel wastage is reduced significantly, save lap length steel.
3. Steel congestion is reduced due to elimination of laps. This also aides in proper flow of concrete in the critical zones and hence improves the quality of the overall structure.
4. Using couplers provides superior cyclic performance as compared to lap joint it also allows greater flexibility for the designer
5. It is possible to easily verify joint strength in case of coupler as compared to lap splice where testing is cumbersome and not regulated.
6. For the contractor usage of coupler reduces labour cost for installation and handling of steel. The construction schedule is improved and there is saving on valuable crane time on project
7. In last steel wastage and lap is reduced that is definitely save MONEY AND PRECIOUS TIME.

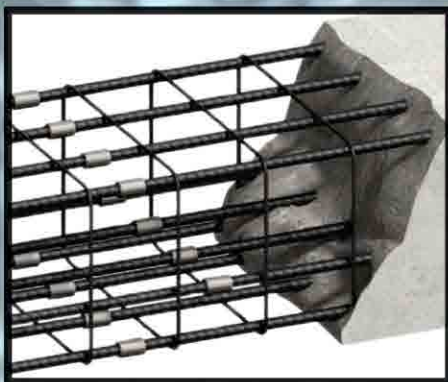



# ANCHORAGE SYSTEMS

## ROUND ANCHOR SYSTEM



## FLAT ANCHOR SYSTEM



## WEDGE (GRIPS)





# HYDRAULIC SPARES

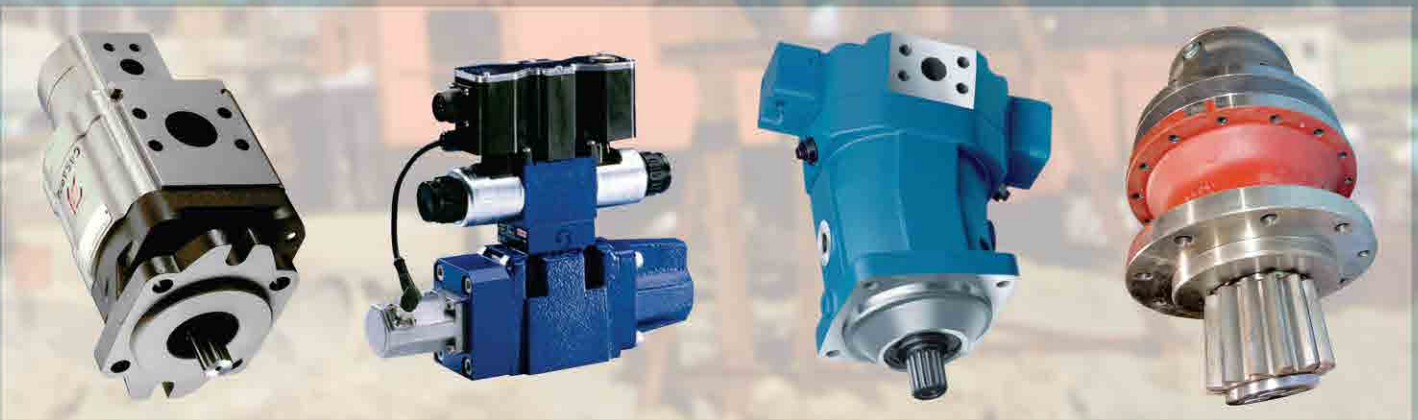

**FOR PILING RIGS & VIBRO HAMMERS**  
**MAIT, BAUER, SOIL MEC, IMT, CASAGRANDE, SANY, ICE, PVE & FAV**

**KAMAR Hydraulics** spares department Distributor of new Hydraulic Components as well as electrical components used in piling rigs & vibro hamers.  
We distribute products manufactured by premier companies and leaders in their respective industries.



# VIBRO SPARES



**VIBRO HAMMERS SPARES FOR ICE, PTC, PVE & FAV**



# CRAWLER CRANE SPARES

*MANITOWOC, AMERICAN, LINK BELT,  
KOBELCO, HITACHI-SUMITOMO  
Crawler crane Undercarriage parts*

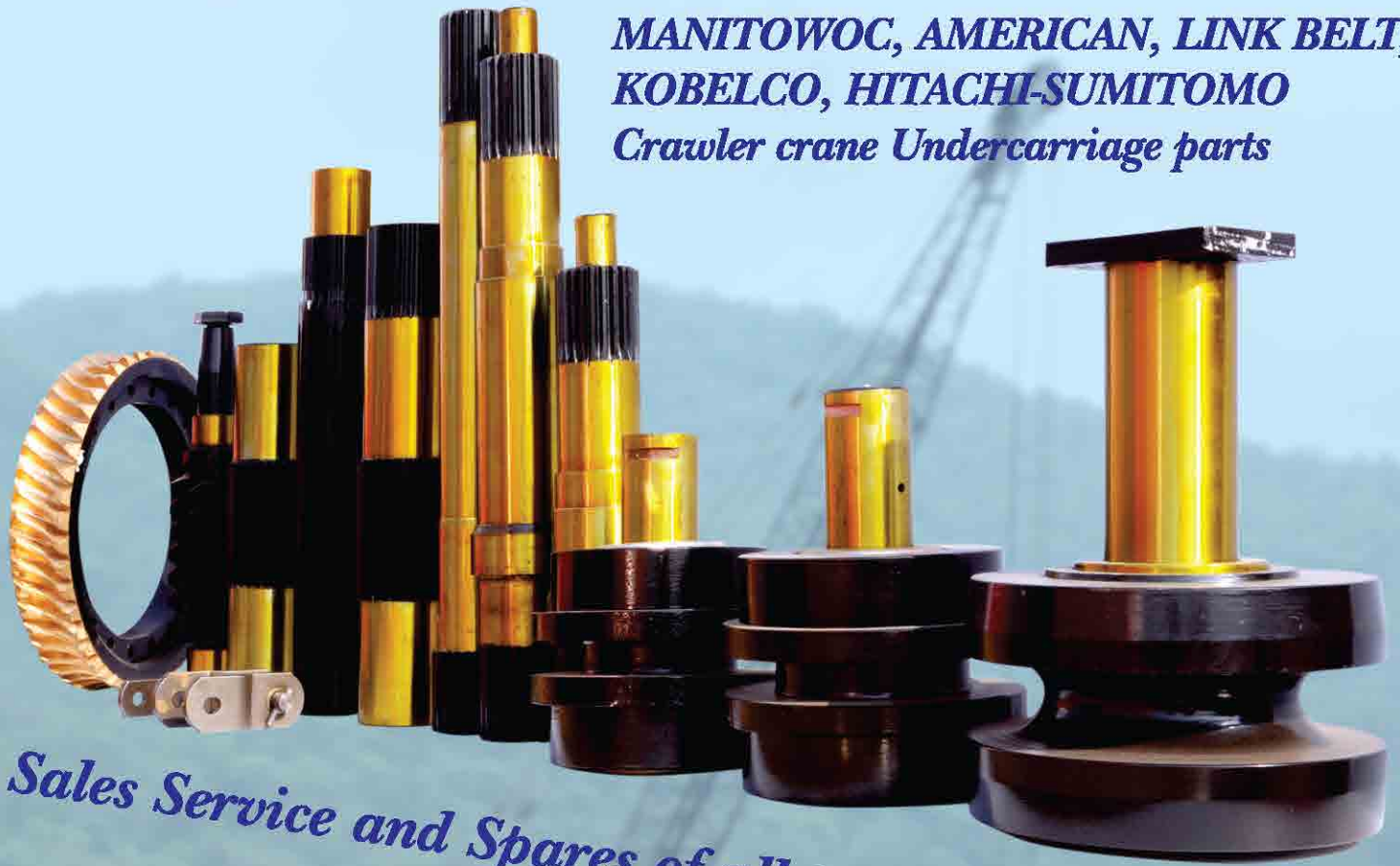

*Sales Service and Spares of all types of Crawler Crane*



**TATA P&H 320 / 325 / 330 / 335 /  
440 / 550 / 655 / 955 / 1055 / TFC-280**



# PARTICIPATE IN EXPO



**BAUMA MUNICH 2010**



**CONEXPO RUSSIA 2010**



**EXCON BANGALORE 2010**



**BAUMA CONEXPO INDIA 2011**



**BAUMA CONEXPO INDIA 2013**



**BAUMA MUNICH 2013**





**HEAD OFFICE :**

Kamar Estate, Devicha Pada,  
Behind Deepak Nitrite Ltd.,  
Taloja MIDC, Taluka : Panvel, Dist.: Raigad,  
Maharashtra - 410 208. ( INDIA )  
Direct No : +91 22 - 2740 1462  
Tel.: +91 22 - 2741 0766 / 2741 0768  
Fax : +91 22 - 2740 1460 / 2740 1458.  
E-mail : [info@kamargroup.com](mailto:info@kamargroup.com)

**CORPORATE OFFICE :**

20, Husain Patel Marg, Mazgaon, Mumbai - 10. ( INDIA )  
Tel.: +91 22 - 2377 6024 / 2371 1811  
Fax : +91 22 - 2371 3708

**REGIONAL OFFICES :**

**Delhi : +91 9990 330 130**

**Hyderabad : +91 8978 634 443**

**Kolkata : +91 9051 916 120**

**Chennai : +91 9629 369 128**

**Dealer :**

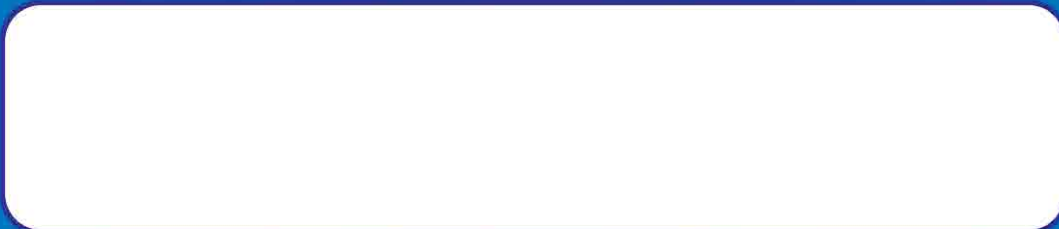

**[www.kamartools.com](http://www.kamartools.com)**